



EHDI
CONFERENCE

10th Annual Early Hearing Detection and Intervention Conference

2011
Program
BOOK

Celebrating the Past

10 Years

Shaping the Future

February 21-22, 2011
Atlanta, GA
Omni Hotel at CNN Center

www.EHDIconference.org

vivosonic

LUNCH & LEARN SEMINAR Quality Improvements in Newborn Hearing Screening

Vivosonic is pleased to host a special Lunch & Learn Seminar on **February 22nd from 12:00-1:30**. Our speakers will share their initiatives to advance best practices and improve quality outcomes in newborn hearing screening programs.

Seating is limited. Please visit the Vivosonic booth in the exhibit hall to sign up.

Quality Improvement Initiatives in Service Provision

Understand the pain points of an independent service provider of newborn hearing screening programs. Learn about initiatives that reduce rescheduling and rescreening, impact quality outcomes, and save significant hospital resources.

Presenter: Steve Jennings, CEO Ears & Hearing



Reducing Loss to Follow-up

Learn how non-sedated ABR measurement can significantly reduce loss to follow-up and enable timely intervention. Non-sedated ABR enables newborn hearing screening programs to diagnose more infants with hearing loss before 3 months of age within the Healthy People 2010 Guidelines.

Presenter: Elizabeth Abbey, M.A., CCC-A, Sound Beginnings EHDI Coordinator, Kansas Department of Health and Environment

Presenter: Mary Horsch, Au.D., CCC-A, Via Christi Health, Kansas



Advanced Technologies at the Heart of Vivosonic Products

Gain a basic understanding of the advanced technologies that enable superior ABR detection, better handling of myogenic artifact, better immunity to electromagnetic interference, and wireless convenience.

www.vivosonic.com

Date: Tuesday, February 22, 2011
Time: 12:00-1:30
Location: Please ask at the Vivosonic booth

Seating is limited. Have you registered?

Paid Advertisement. Information in this advertisement does not reflect any type of endorsement by the EHDI Conference Co-sponsors or Planning Committee.



Table of Contents

General Information

Acknowledgements 4
Welcome / Co-Sponsors 5
About the EHDI Conference / Learning Objectives..... 6
Participant Notices 7
Conference Highlights 8
Networking 9
Learning Opportunities 10

Antonia Brancia Maxon Award

Antonia Brancia Maxon Award for EHDI Excellence Description. 12
Antonia Brancia Maxon Award for EHDI Excellence Past Recipient Highlight..... 13

Agenda

Pre-Conference Meetings 16
Sub-Group Meetings Taking Place During the Conference..... 16

Photos in this program are courtesy of

Advanced Bionics
 Centers for Disease Control and Prevention
 Cochlear Americas
 John Tracy Clinic
 MED-EL
 Natus Medical
 The National Center for Hearing Assessment and Management
 Oticon A/S
 Phonak
 Siemens Hearing Instruments
 Sound Beginnings / Utah State University

Conference Agenda..... 17-32
 Topical Session 1 (Monday morning) 17-19
 Topical Session 2 (Monday afternoon)..... 19-20
 Topical Session 3 (Monday afternoon)..... 20-21
 Topical Session 4 (Tuesday morning)..... 22-24
 Topical Session 5 (Tuesday morning)..... 24-25
 Topical Session 6 (Tuesday afternoon)..... 26-27
 Topical Session 7 (Tuesday afternoon)..... 27-28
 Plenary Session Abstracts and Speaker Biographies 29-32

Posters / Exhibits

Poster Hall Layout..... 34
Poster Presentations 35-37
Exhibit Hall Layout..... 38
List of Exhibitors 39

State Stakeholders' Meeting

State Stakeholders' Meeting Description 42
Pre-Conference Individual Reflection and Planning..... 43
Team Up Form 44-45
Individual Post-Conference Plan..... 46

Presenter Index

Presenter Index..... 48-52

Notes

Session Notes and Applications 54-57
Note Pages 58-60

Continuing Education Units (CEUs)

Continuing Education Units (CEUs) Overview 62
American Academy of Audiology Application Instructions 63
American Academy of Audiology Attendance Form..... 65
American Academy of Audiology Learner Assessment..... 66
American Speech-Language-Hearing Association Application Instructions..... 67
American Speech-Language-Hearing Association Participant Form..... *Insert - Back Pocket*
AG Bell Academy for Listening and Spoken Language Application Instructions..... 69
AG Bell Academy for Listening and Spoken Language CEU Forms..... *Insert - Back Pocket*

Evaluations

Overall Conference Evaluation..... 73-74
Poster Evaluation 75
State Stakeholders' Meeting Evaluation 77

Hotel Map / Local Information

Local Information and Transportation..... 79
Hotel Map..... 80-81

Back Outside Cover

Agenda at a Glance

The conference organizers recognize and thank the members of the 2011 EHDl Conference Planning Committee for their hard work and dedication in creating an engaging and productive conference.

CO-SPONSOR REPRESENTATIVES

- Faiza Khan American Academy of Pediatrics (AAP)
- John Eichwald Centers for Disease Control and Prevention (CDC)
U.S. Department of Health and Human Services
- Irene Forsman Maternal Child Health Bureau (MCHB)
Health Resources and Services Administration (HRSA)
U.S. Department of Health and Human Services
- Karl White National Center for Hearing Assessment and Management (NCHAM)
Utah State University

PLANNING COMMITTEE MEMBERS

- Martin Beals American Academy of Pediatrics EHDl Task Force
- Krista Biernath EHDl Team, NCBDDD-Centers for Disease Control and Prevention
- Susan Elliott Douglas County School District, Colorado; Hands & Voices National, Walden University
- Chelsea Fosse American Academy of Pediatrics
- Brad Golner American Academy of Pediatrics EHDl Task Force
- Karen Hopkins Maine Educational Center for the Deaf and Hard of Hearing
- Vicki Hunting University of Iowa Child Health Specialty Clinics, Iowa Hands & Voices
- Deanna McPherson HRSA, U.S. Department of Health and Human Services
- Ginger Mullin University of Illinois at Chicago – Division of Specialized Care for Children
- Terri Patterson Georgia Hands & Voices
- Sarah Rank Georgia Department of Community Health, Maternal and Child Health Programs
- Stevenson Richardson EHDl Team, NCBDDD-Centers for Disease Control and Prevention
- Sharon Ringwalt National Early Childhood Technical Assistance Center (NECTAC)
- Howard Rosenblum National Association of the Deaf, Equip for Equality, Midwest on Law and the Deaf (MCLD)
- Jackson Roush University of North Carolina School of Medicine, Division of Speech and Hearing Sciences
- Alice Sette Alabama Department of Rehabilitation Services (Children’s Rehabilitation Service)
- Kathleen Treni Alexander Graham Bell Association for the Deaf and Hard of Hearing
- Lisa Weiss National Cued Speech Association and Cued Speech of Colorado

CONFERENCE STAFF

- Mandy McClellan Conference Coordinator, NCHAM
- Jamie Elliott-Cousins Consultant, NCHAM
- Casey Judd Utah State University Conference Management Services
- Melanie Klein Utah State University Conference Management Services

SPECIAL THANKS

We would also like to thank the Abstract Review Committee for lending time and expertise, Room Monitors for helping the conference run smoothly, and all of the contractors whose behind the scenes magic allows us to enjoy and get the most out of the conference.

CONFERENCE MANAGEMENT SERVICES PROVIDED BY

Utah State University Conference Management Services
A service of the University Inn & Conference Center
5005 Old Main Hill | Logan, Utah 84322-5005
800-538-2663 | www.conference.usu.edu



Welcome



Celebrating the Past, Shaping the Future of EHDI Programs

Welcome to Atlanta! In 2011 we are celebrating the 10th Anniversary of the National Early Hearing Detection and Intervention (EHDI) Conference. There is much to celebrate as a diverse group of stakeholders comes together from all over the United States and the world with the shared goal of providing better services to infants and young children who are deaf or hard-of-hearing and their families. As we reflect on our progress and imagine the shape of EHDI in the future, conference participants will spend many hours listening, debating, planning, and dreaming of how to make the world a better place for children with hearing loss and their families.

The Conference activities provide a wonderful opportunity to become energized by new ideas, evaluate what we have been doing, re-connect with old friends and make new ones, discover resources that can help achieve our goals, and gain a better perspective about what is most important. Outstanding presentations, posters, exhibits and other activities will provide opportunities to learn about, critique, and discuss every aspect of a successful EHDI system.

There will be much that enlightens and motivates, but there will also be areas of disagreement. Hopefully all discussions can be done in a way that is safe for everyone and motivates everyone to add information to the pool of knowledge. It is only by understanding and thoughtfully considering the contributions of all stakeholders that the goal of having the best possible EHDI programs for children and families can be achieved.

Almost 100 years ago, George Bernard Shaw said,

You see things; and you say, "Why?"

But I dream things that never were; and I say, "Why not?"

His words ring true today as we celebrate the past and shape the future of EHDI programs.

Enjoy your time at the conference, learn much, be re-invigorated, and then go back to your homes to continue changing the world!

CO-SPONSORING ORGANIZATIONS

American Academy of Pediatrics (AAP)

U.S. Department of Health and Human Services: Centers for Disease Control and Prevention (CDC)

U.S. Department of Health and Human Services: Health Resources and Services Administration (HRSA)

National Center for Hearing Assessment and Management at Utah State University (NCHAM)

ABOUT THE CONFERENCE

The Early Hearing Detection and Intervention (EHDI) Conference has built a strong reputation for bringing together a wide variety of attendees including those who:

- work in state EHDI programs;
- assist in EHDI efforts on the federal level;
- provide screening, diagnostic, and early intervention support at the state/local level to young children with hearing loss and their families;
- champion Medical Home activities within each state;
- are family members of children with hearing loss;
- are deaf or hard-of-hearing adults who are helping to expand opportunities for young children with hearing loss;
- are academicians (faculty and students) engaged in education or research related to EHDI.

The conference combines lectures, panel discussions, and strategic planning sessions to allow you the opportunity to interact with your colleagues in solving the problems you encounter related to EHDI in daily practice and in policy and programmatic activities.

CONFERENCE GOAL

The goal of this conference is to enhance the implementation of comprehensive state-based Early Hearing Detection and Intervention (EHDI) programs.

LEARNING OBJECTIVES FOR CONFERENCE PARTICIPANTS

- Identify and promote knowledge and awareness of successful strategies for implementing comprehensive state-based EHDI programs that include screening, audiologic diagnostic evaluation, early intervention, medical home, reporting, tracking, surveillance, loss to follow-up issues, data integration, and other related surveillance components.
- Interpret and describe current research and research methods related to EHDI.
- Examine cultural competence of providers and assess their ability to work with children who have a hearing loss, their families, and communities.
- Discuss the importance of enhancing and creating new and ongoing working relationships among federal agencies, non-profit organizations, state health departments and educational agencies, advocacy groups, families, and professionals.



CONFERENCE HISTORY



1st Annual: February 11–13, 2002
 2nd Annual: February 24–26, 2003
 3rd Annual: February 18–21, 2004
 4th Annual: March 3–4, 2005
 5th Annual: February 2–3, 2006
 6th Annual: March 26–27, 2007
 7th Annual: February 25–26, 2008
 8th Annual: March 9–10, 2009
 9th Annual: March 1–2, 2010
 10th Annual: February 21–22, 2011

Tysons Corner Marriott Hotel, Vienna, Virginia
 Renaissance Atlanta Hotel Downtown, Atlanta, Georgia
 Renaissance Mayflower Hotel, Washington, D.C.
 Renaissance Atlanta Hotel Downtown, Atlanta, Georgia
 Renaissance Washington D.C. Hotel, Washington, D.C.
 Salt Lake City Marriott Downtown Hotel, Salt Lake City, Utah
 Astor Crowne Plaza Hotel, New Orleans, Louisiana
 InterContinental Dallas Hotel, Addison, Texas
 InterContinental Chicago O'Hare Hotel, Rosemont, Illinois
 Omni Hotel at CNN Center, Atlanta, Georgia

PARTICIPANT NOTICES



CONFERENCE REGISTRATION (Grand Ballroom Lobby on M4)

Sunday, February 20	7:15 AM–8:00 PM
Monday, February 21	7:15 AM–3:30 PM
Tuesday, February 22	7:15 AM–12:00 PM

The conference registration desk will be managed by Utah State University Conference Services during the hours listed above. Should you need assistance with any aspect of the conference, please feel free to contact any of the conference staff there.

PARTICIPANT LIST

A copy of the participant list and exhibitor list is located in the back pocket inserts.

SPEAKER READY ROOM (Cypress Room on M2)

Sunday, February 20	6:00 PM–8:00 PM
Monday, February 21	7:15 AM–5:30 PM
Tuesday, February 22	7:15 AM–3:15 PM

Presenters should take their PowerPoint presentations to the Speaker Ready Room during these hours to have presentations pre-loaded to their session room. Please do this as soon as possible after your arrival at the conference.

MESSAGE BOARD (Grand Ballroom Lobby on M4)

A message board will be provided near the conference registration desk to post any last minute schedule changes or important conference announcements. Participants may also use the board to communicate with other participants. Check the board often for messages and updates.

SESSION HANDOUTS

Presenters were asked to bring copies of their session handouts. If handouts were not provided, please contact the session presenter directly, or look online as some presenters uploaded their handouts to <http://ehdiconference.org/Schedule/grid.cfm?day=SUNDAY>

NAME BADGE AND RIBBONS

Your conference name badge will admit you to all conference sessions and activities. To assist you in networking with other participants and conference staff, color coded ribbons have been provided as follows:

Staff	Aqua	Exhibitor	Red	Parent	Leaf
Speaker	Black	Room Monitor	Blue	MCH Graduate Student	Orange
Plenary Speaker	Forest Green	Concierge	Jade	LEND Graduate Student	Orange
Poster Presenter	Carolina Blue	I Can Sign	Violet		

CELL PHONES

Please turn off all cell phones and alarm systems during all conference sessions so as not to distract presenters or other participants. We thank you for your cooperation.

LUGGAGE STORAGE ON TUESDAY

For those who will be checking out of their hotel rooms Tuesday morning, luggage storage will be provided. You may leave your luggage with the bellman at the Cottonwood Room on M1 (across from the hotel front desk in the NORTH tower).

SMOKING

We appreciate your consideration of others by smoking only outdoors. Thank you.

EVALUATION FORMS

The conference co-sponsors wish to make the EHDl Conference as beneficial as possible to the participants. You are encouraged to complete evaluations for each of the sessions you attend, including the poster session. Your responses will help the Planning Committee improve activities for future EHDl Conferences. We greatly appreciate your time and feedback!

Pre-Conference Session Evaluation – At each pre-conference session you attend, you will be given an evaluation form to evaluate that session. Return these forms to the room monitor upon leaving the session.

Breakout Session Evaluation – At each session you attend, you will be given an evaluation form to evaluate that session. Return these forms to the room monitor upon leaving the session.

Poster Evaluation – You will find this evaluation form in this booklet on page 75. To help ensure quality posters at the EHDl Conference, please complete an evaluation form for each poster you visit. Poster evaluation forms will also be available throughout the poster area. Return this form to the conference registration desk before leaving the conference.

Overall Conference Evaluation – You will find this evaluation form in this booklet on page 73. Return this form to the conference registration desk before you leave the conference.



State Stakeholders' Meeting Evaluation – You will find this evaluation form in this booklet on page 77. Help improve the State Stakeholders' Meeting sessions by providing your feedback. Return this form to the conference registration desk before you leave the conference.

STATE STAKEHOLDERS' MEETING (LOCATIONS ARE LISTED IN THE BACK POCKET INSERTS)

This meeting will provide a structure and support for attendees at the conference who are from the same state to work together to improve their state EHDI system. Please plan to attend this session.

State Stakeholders' Meeting

Monday, February 21
9:45 AM–10:35 AM

POSTER SESSION WITH PRESENTERS (INTERNATIONAL BALLROOM F on M2)

Posters will be available for viewing throughout the conference. Poster presenters will be on hand during the poster session time listed below.

Poster Setup*	Sunday, February 20	6:00 PM–8:00 PM
	Monday, February 21	7:00 AM–8:00 AM
Poster Session	Monday, February 21	12:45 PM–1:45 PM
Poster Take Down**	Tuesday, February 22	2:45 PM–3:00 PM

*All posters are to be mounted by 8:00 AM on Monday morning.

**You may leave your poster at the conference registration desk until after the closing plenary, if needed. Any posters not picked up by 5:00 PM Tuesday, will be discarded.

PRESENTATION OF POSTER AND WEBSITE AWARDS

A panel of judges will evaluate all posters presented at the conference based on the content and presentation. Blue ribbons will recognize the best posters. Additionally, a committee of EHDI stakeholders has evaluated the websites of all states and territories to select those that do the best job of providing accurate, useful, timely, and comprehensive information. The award winners for both posters and websites will be recognized prior to the plenary session on Tuesday morning.

Tuesday, February 22 9:00 AM–9:20 AM Grand Ballroom on M4

PRESENTATION OF ANTONIA BRANCIA MAXON AWARD FOR EHDI EXCELLENCE

Join us in honoring the 2011 nominees and recipient(s) and celebrating their contributions to EHDI.

Monday, February 21 5:10 PM–5:20 PM Grand Ballroom on M4

EXHIBITOR HOURS (GRAND BALLROOM on M4)

Monday, February 21 7:15 AM–7:30 PM
Tuesday, February 22 7:15 AM–2:30 PM





RECEPTION & ENTERTAINMENT

Stroll the exhibit hall, enjoy some light fare, and catch up with colleagues and friends at the reception. Then experience Manga African Dance, Inc. and their high-energy repertoire, which includes dances and rhythms from Ghana, Senegal, Guinea, Gambia, Liberia, South Africa and Nigeria. The group is a non-profit organization founded in 1990 by Ramatu Afegbua-Sabbatt and incorporated in the State of Georgia in 1996. They are dedicated to preserving, presenting and teaching indigenous African cultural Arts through African Dance, Drama, Songs, Games, Fashion, Drum and Adornment. They were featured in the opening and closing ceremonies of the 1996 Olympic Games.

Reception (GRAND BALLROOM/EXHIBIT HALL on M4)

Monday, February 21

5:45 PM–7:30 PM

Entertainment (GRAND BALLROOM on M4)

Monday, February 21

6:30 PM–7:30 PM

THE PARENT PLACE

(TABLES IN PREFUNCTION LOBBY 1 on M2)

Look for the “Parent” ribbon on participant name badges.

Come to The Parent Place throughout the conference to meet and mingle with other parents and family members of children who are deaf or hard-of-hearing.

THE STUDENT PLACE

(TABLES IN PREFUNCTION LOBBY 2 on M2)

Come to The Student Place throughout the conference to meet and mingle with other students.





INFORMAL LUNCH GATHERINGS

THE PARENT PLACE – LUNCH MEETING (INTERNATIONAL BALLROOM E on M2)

This is an opportunity for parents and family members to meet in a more structured setting during lunch on Monday. Pick up a boxed lunch from the Exhibit Hall, then come network with other family members!

Monday, February 21
12:15 PM–1:30 PM

“OUR TOWN” – LUNCH MEETING (GRAND BALLROOM LOBBY on M4)

Come learn more about the “Our Town” curriculum with planned learning activities done a fun way! “Our Town” will give a glimpse of what goes on in the Deaf bilingual community! Challenge yourself to learn 100 signs by the end of the conference! Grab your lunch and come learn with others!

Tuesday, February 22
12:15 PM–1:30 PM

EHDI COMMUNIVERSITY: COMMUNITY, COMMUNICATE, DIVERSITY, AND LEARNING

BOOTHS IN GRAND BALLROOM LOBBY on M4

The goal of the EHDI Communiversity is to help conference participants understand and appreciate the wonderfully heterogeneous culture and daily activities of people who are deaf or hard of hearing. The EHDI Communiversity underscores the need to deliver Community-based services that promote effective Communication skills for all children who are deaf or hard of hearing, while respecting the Diversity of participating families and Learning about different points of view and the daily lives of people who have chosen various ways of communicating in their families---ranging from Cued Speech, to Listening and Spoken Language to American Sign Language.

“OUR TOWN”

Our Town is an interactive series of cultural immersion activities designed for parents of Deaf and Hard of Hearing children to gain a greater awareness of resources and perspectives that contribute to healthy social and emotional growth. Our Town includes cultural experiences that build a sense of ‘connectedness’ and self-esteem while contributing to identity development. There will be opportunities to visit with a variety of D/HH people of all ages and backgrounds who are open to share their experiences. Enjoy visual music produced by Deaf Performing Artists, explore video communication using 4G mobile phones and much more. Pick up a free CD of the Our Town powerpoints while they last!

AMERICAN SIGN LANGUAGE (ASL) FOR EVERYBODY

Look for the “I Can Sign” ribbon on participant name badges.

Are you curious about American Sign Language? Want to practice your skills? Join us throughout the conference at the ‘ASL for Everybody’ table where experienced signers and facilitators will be “on hand” to encourage you in your efforts! Be prepared to socialize, ask any questions you have, and most of all, to have fun!

CUED SPEECH

Accessing English using Cued Speech ensures clear communication and literacy skills. Learn how Cued Speech can show rhymes, animal sounds, and environmental stimuli! Learn how to cue a few words and phrases. See someone cueing fluently, watch some short nursery rhymes and the story of the Three Bears in cued English.

LISTENING AND SPOKEN LANGUAGE

The possibilities for today’s infants and children who are deaf or hard of hearing and their families are endless, indeed! Come get a glimpse of the day-to-day experiences of families thriving in a listening and spoken language environment. Be sure to watch a brief video where teenagers share their Leadership Opportunities for Teens adventures!



Antonia Brancia Maxon
Award for EHDI Excellence



Antonia Brancia Maxon Award for EHDI Excellence

The **Antonia Brancia Maxon Award for EHDI Excellence** honors the career achievements of Dr. Antonia Brancia Maxon in promoting effective EHDI programs for all newborns, infants, and young children. Dr. Maxon was a visionary in EHDI programs, beginning with her leadership in the Rhode Island Hearing Assessment Project in the late 1980's. She was one of the first to recognize the feasibility and value of universal newborn hearing screening and was a tireless advocate for connecting screening programs with timely and appropriate diagnosis and early intervention.

Her extensive contributions to creating excellent EHDI programs were abruptly ended by a tragic automobile accident in May of 2007. In memory of her contributions, an **Award for EHDI Excellence** is presented at the annual EHDI Conference to honor an individual or group of people who have made a noteworthy accomplishment that contributed to achieving excellence in EHDI programs nationally or in a particular state or region of the country.

Presentation of the 2011 Award

**Grand Ballroom on M4
Monday, February 21
5:10 PM-5:20 PM**



**Thank you to all those who
submitted nominations for this
year's award.**



ANTONIA BRANCIA MAXON AWARD FOR EHDI EXCELLENCE

Past Recipients of the Antonia Brancia Maxon Award for EHDI Excellence

2010 Recipients

Beth Benedict's passion is to ensure that all families with children who are deaf or hard of hearing are informed and empowered and that these children have access to high-quality services that promote success in language, literacy, and life. Beth exemplifies the best in collaboration and partnerships through her work with deaf and hearing communities. For more than twenty years she has been a mentor to families with newly identified children. Beth currently serves as the president of the American Society for Deaf Children and is a professor at Gallaudet University.

Beth has been a key figure on EHDI conference planning and proposal review committees. She regularly presents at the EHDI conference and has influenced EHDI systems to recognize and acknowledge the range of communication opportunities available to children and families. She serves as a Council on Education of the Deaf (CED) representative to the Joint Committee on Infant Hearing, is a member of the Maryland Universal Newborn Hearing Screening Advisory Council and often consults on early intervention and family involvement projects. Beth's involvement in EHDI systems improvement spans topic areas, type of audience, and venue. Her respect for and sensitivity to various points of view has earned her the esteem of colleagues across the field. As the parent of two deaf children, a member of the deaf community, and a professional in academia, her experience is broad and deep.

Albert Mehl has been a pioneer in newborn hearing screening since 1992 when he was asked to help implement a newborn hearing screening program at Boulder Community Hospital. Little did he know that this would become his second career. He was crucial in passing Colorado's newborn hearing legislation in 1997. Representing the physician's role and the importance of early identification, he helped convince legislators that newborn hearing screening was the right thing to do for all children. As a result of the legislation, a formal advisory committee was developed, and Al was selected as the chair. Twelve years later he continues to lead the advisory committee providing insight, support and practical wisdom to the ever-changing needs of EHDI programs. He serves as the American Academy of Pediatrics (AAP) representative on the Joint Committee on Infant Hearing and has written several articles that have been published in the AAP Journal and are quoted frequently – all of this while maintaining a full time pediatric practice. As a primary health care provider, Al has been instrumental in supporting the medical home approach, working together as a team with the audiologist, Hands & Voices parent guide and early interventionist for the benefit of the child and the family.

Vickie Thompson was the EHDI Coordinator in Colorado before the official job existed. In 1991 she initiated one of the first universal screening programs in the world at Boulder Community Hospital and became the consultant for the Colorado Department of Health to promote and support Newborn Hearing Screening programs statewide shortly thereafter. She was the Newborn Screening Coordinator at the Marion Downs Hearing Center (MDHC) and has been on the Professional Advisory Committee of the MDHC since 1996. In 1998 she was instrumental in creating the Colorado Infant Hearing Advisory Board which has led to the improvement of EHDI programs in Colorado. At that time the concept of an advisory board was unique, and Vickie's creativity and vision led to an advisory board concept, which became the model for other states. Under Vickie's leadership, Colorado consistently meets the EHDI goals set by the Joint Committee for Infant Hearing and has become a model that is emulated by many other states.

2009 Recipients: Leeanne Seaver and Janet DesGeorges

2008 Recipients: Judith Gravel & Mary Hartnett

(more information about the accomplishments of each of the recipients of the Antonia Brancia Maxon Award for EHDI Excellence can be found at <http://ehdiconference.org/Award.cfm>)



Barton G. Kids Hear Now Cochlear Implant Family Resource Center

Hearing loss is the most common type of birth defect and affects over 12,000 newborns each year. Just a little over a decade ago, a child born deaf had little hope of hearing, but today, cochlear implantation surgery can provide a child who is born deaf with the ability to hear. A comprehensive international program for cochlear implant patient care the University of Miami Ear Institute, through the aid of its Cochlear Implant Program, has helped restore hearing to more than 1,200 children and adults.



Understanding that the diagnosis of deafness can be devastating and families of hearing impaired children face unique challenges the University of Miami Ear Institute offers hope to those recently diagnosed with the establishment of the **Barton G. Kids Hear Now Cochlear Implant Family Resource Center**. The Center and its team of experts are dedicated to providing a seamless process that takes into account the social and emotional aspects of deaf children and their families while offering the most current medical technology available. Providing state-of-the-art, patient-centered services including psychological counseling, pre and post surgical consultations, mentoring, support groups and educational outreach the Center is a place where families from all walks of life can receive the resources and support they need to transition deaf children from an existence without sound to a hearing world through the use of cochlear implant technology.

Additional information regarding the **Barton G. Kids Hear Now Cochlear Implant Family Resource Center** is available online at <http://khnfamilyresourcecenter.org> or by calling 888-9COCHLEAR.



Paid Advertisement. Information in this advertisement does not reflect any type of endorsement by the EHDI Conference Co-sponsors or Planning Committee.





PRE-CONFERENCE MEETINGS (All are by invitation only.)

Pacific Rim EHDI Programs	Saturday, February 19	8:00 AM–5:00 PM	Dogwood A on M1
People involved in implementing EHDI programs in the Pacific Rim will meet to discuss how they can coordinate efforts and learn from each other. More information is available from Yusnita Weirather, yusnita.weirather@hawaiiintel.net .			
T83 Grantee/Project Officer Meeting	Sunday, February 20	3:00 PM - 5:00 PM	Beechnut on M3
MCH-LEND Dinner	Sunday, February 20	5:30 PM–7:30 PM	Int’l Ballroom D on M2
Conference of Educational Administrators of Schools and Programs for the Deaf Members’ Meeting	Sunday, February 20	6:00 PM–7:00 PM	Walnut on M3
AAP Chapter Champions Networking Session	Sunday, February 20	6:30 PM–8:30 PM	Dogwood A on M1
Students Involved in EHDI: Meet and Greet Reception	Sunday, February 20	7:30 PM–9:00 PM	Int’l Ballroom E on M2
During the lunch break on Tuesday, all students and associated faculty who have been attending the EHDI Conference are invited to bring their own lunch to the International Ballroom D on M2 to debrief about their experiences and discuss what they have learned and what they plan to do as a result of attending the National EHDI Conference.			

SUB-GROUP MEETINGS DURING CONFERENCE (All are by invitation unless otherwise noted.)

Part C & EHDI Work Group Lunch Meeting	Monday, February 21	12:00 PM–1:45 PM	Beechnut on M3
The purpose of the Part C & EHDI Work Group is to increase collaboration between Part C and EHDI programs in order to strengthen services to children and families as they progress through the EHDI continuum. This meeting is an invited participant work session. For more information, contact Karen Clark at 214-769-4749 or kclark@utdallas.edu .			
The Parent Place Lunch Meeting (Open to All)	Monday, February 21	12:15 PM–1:30 PM	Int’l Ballroom E on M2
Parents and family members of children who are deaf/hard of hearing are invited to pick up a boxed lunch and gather together to meet with other family members in a casual, but structured, setting.			
AAP Chapter Champions Dinner	Monday, February 21	6:30 PM–9:00 PM	TBA
“Our Town” Discussion (Open to All)	Tuesday, February 22	12:15 PM–1:30 PM	Tables in Grand Ballroom Lobby on M4
Welcome to Our Town! You’re invited to get a glimpse of what goes on in the deaf community! Experience some cultural immersion activities, gain an awareness of resources and learn how a sense of connectedness can be built to benefit children who are D/HH. Enjoy an interactive discussion that will definitely send you home with new insights! Lunch is on your own. You may bring lunch with you to the discussion.			
Students Involved in EHDI Lunch	Tuesday, February 22	12:15 PM–1:30 PM	Int’l Ballroom D on M2
AAP Chapter Champions Working Lunch	Tuesday, February 22	12:15 PM–1:30 PM	Dogwood A on M1
State EHDI Program Coordinators’ Meeting	Wednesday, February 23	8:00 AM–3:00 PM	Dogwood A & B on M1
The EHDI coordinator from all states and territories (or their designee) is required to participate in this “grantee meeting” for all recipients of grants or cooperative agreements from MCHB or CDC for EHDI programs. Issues related to procurement, grants management, reporting, and new initiatives related to will be discussed. More information is available at http://ehdiconference.org/PreCon.cfm?type=coordinator .			



Saturday, February 19, 2011

8:00 AM - 5:00 PM	Pacific Rim Meeting	Dogwood A on M1
9:00 AM - 4:00 PM	JCIH Meeting	Chestnut on M3
1:00 PM - 5:00 PM	DSHPHWA Executive Board Meeting	Beechnut on M3

Sunday, February 20, 2011

PRE-CONFERENCE SESSIONS

7:15 AM - 8:00 PM	Registration Open	Grand Ballroom Lobby on M4
8:00 AM - 5:00 PM	DSHPHWA Meeting	International Ballroom E on M2
12:00 PM - 2:00 PM	Language Acquisition and Brain Development of Children Who Are Deaf or Hard of Hearing	Dogwood A on M1
12:00 PM - 2:00 PM	IDEA Training for EHDI Professionals	Magnolia on M2
1:00 PM - 5:00 PM	The Pediatric Medical Home and EHDI: An Important Piece of the Puzzle	Dogwood B on M1
1:00 PM - 5:00 PM	Culturally Competent Practices in EHDI	International Ballroom A on M2
2:00 PM - 5:00 PM	Individuals with Disabilities Education Act (IDEA) Training for Parents	Redwood on M1
2:00 PM - 5:00 PM	Early Childhood Hearing Screening	International Ballroom B on M2
3:00 PM - 5:00 PM	Using IT Applications for Games, Shopping and...EHDI??? - Can this really help my program?	International Ballroom C on M2
3:00 PM - 5:00 PM	T83 Grantee/Project Officer Meeting	Beechnut on M3
5:30 PM - 7:30 PM	MCH-LEND Dinner	International Ballroom D on M2
6:00 PM - 8:00 PM	Exhibit Set-up	Grand Ballroom on M4
6:00 PM - 8:00 PM	Poster Set-up	International Ballroom F on M2
6:00 PM - 8:00 PM	Speaker Ready Room open	Cypress on M2
6:30 PM - 8:30 PM	AAP Chapter Champion Networking Session	Dogwood A on M1
7:30 PM - 9:00 PM	Students Involved in EHDI: Meet and Greet Reception	International Ballroom E on M2

Monday, February 21, 2011

7:15 AM - 8:30 AM	Continental Breakfast	Grand Ballroom on M4
7:15 AM - 3:30 PM	Registration Open	Grand Ballroom Lobby on M4
7:15 AM - 5:30 PM	Speaker Ready Room Open	Cypress on M2
7:15 AM - 7:30 PM	Open Time to Visit Exhibits	Grand Ballroom on M4
8:15 AM - 9:15 AM	Opening Plenary (see abstract on page 29) Moderator: Irene Forsman	Grand Ballroom on M4
	Ten Years of EHDI Presented by Bonnie Strickland, John Eichwald, Louis Cooper, and Karl White	
9:15 AM - 9:25 AM	Overview of State Stakeholders' Meeting	Grand Ballroom on M4
9:25 AM - 9:45 AM	Refreshment Break	Grand Ballroom on M4 and Pre-Function Lobbies on M2
9:45 AM - 10:35 AM	State Stakeholders' Meeting	Various Locations (see insert)
10:35 AM - 10:55 AM	Break	

Topical Session I *All sessions are 60 minutes. Some contain two 30-minute presentations.

Room - Magnolia on M2

A Collaborative Approach in Improving Data Collection for 1-3-6
Presented by Bridget Roemmich

Increasing Data Quality and Program Evaluation Capacity
Presented by Meuy Swafford, Kristen Becker



10:55 AM - 11:55 AM

Topical Session I (Continued)

Room - International Ballroom E on M2

Once is Not Enough
Presented by Joni Alberg

Caring About Counseling: The Family's Journey
Presented by Johnnie Sexton, Kathleen Watts, Sandra Usrey

Room - International Ballroom D on M2

A Review of Cochlear Implantation in the Georgia Medicaid Population
Presented by Gary Miller

Outcomes in Children who are Deaf-Blind with Cochlear Implants
Presented by Susan Wiley, Kathleen Stremel

Room - International Ballroom C on M2

Be Part of the ECHO: What You Need to Know About Existing Early Childhood Hearing Screening Initiatives in Your State
Presented by Lenore Shisler, Terry Foust, William Eiserman, Jeff Hoffman

OAE Screening in Primary Healthcare Settings - A Pilot Project
Presented by Terry Foust, William Eiserman, Lenore Shisler

Room - International Ballroom B on M2

Strategies for Reducing Loss to Follow-up in EHDI Programs
Presented by Hallie Morrow, Jennifer Sherwood

Diagnostic Audiology Evaluations Via Telemedicine
Presented by Hallie Morrow, Lisa Satterfield

Room - International Ballroom A on M2

The Role of a Multidisciplinary Team Clinic in Evaluating Children with Hearing Loss
Presented by Sandra Gabbard, Shannon Burns, Stacy Claycomb

The TEAM Approach to Maximizing a Child's Communication
Presented by MaryKay Therres, Judy Sexton

Room - Dogwood A on M1

Promoting Hearing Screening for Out of Hospital Births: A Roundtable Discussion
Presented by Rachel St. John, Martin Beals

Room - Dogwood B on M1

It Takes a State (and a Long Time) to Complete a Guideline
Presented by Angelique Boerst, Michelle Garcia

Improving Loss to Follow-up Rates, Establishing Pediatric Audiological Diagnostic Center Guidelines for 2011
Presented by Sarah Stone, Janet Farrell, Rashmi Dayalu



10:55 AM - 11:55 AM	Topical Session I (Continued)	
Room - Redwood on M1		
<i>Music and Movement in Deaf Education Programs</i> Presented by Adrienne King		
<i>Music, Language, Intelligence and the Brain: Theory, Research Findings & Practical Applications for Early Intervention – An Interactive Breakout Session</i> Presented by Natasha Wen		
Room - Juniper on M2		
<i>Early Intervention in Deaf Schools: Adapting to the Needs of Today’s Families</i> Presented by Barbara Raimondo, Rosemary Gallegos, Stella Egbert, Maryann Swann		
<i>Early Intervention Services Provided by Schools for the Deaf - National Survey</i> Presented by Rosemary Gallegos, Ronald Stern		
Room - Walnut on M3		
<i>The IFSP Communication Plan</i> Presented by Janet DesGeorges, Terri Patterson, Richard Wentworth, Erin Schuweiler		
<i>IEPs for High Achievers</i> Presented by Leeanne Seaver		
Room - Hickory on M3		
<i>Family Signs Program: Remote Video Sign Language Instruction via Skype and ooVoo</i> Presented by Lisa Bosson		
<i>SMARTSign-Mobile Sign Language Learning</i> Presented by Harley Hamilton, Kimberly Weaver, Valerie Summet, Thad Starner		
Room - Hazelnut on M3		
<i>Experiencing Deaf Culture: Creating a Friendly Visual Environment at Home</i> Presented by Nancy Kelly-Jones		
11:55 AM - 1:00 PM	Lunch in Exhibit Hall (lunch provided)	Grand Ballroom on M4
12:15 PM - 1:30 PM	Parent Lunch	International Ballroom E on M2
12:45 PM - 1:45 PM	Open Time to Visit Exhibits	
12:45 PM - 1:45 PM	Poster Session	
2:00 PM - 3:00 PM	Topical Session 2	
Room - Magnolia on M2		
<i>Impact of Hearing Loss on the Family</i> Presented by Lisa Kovacs		
Room - International Ballroom E on M2		
<i>Defining Core Competencies for Providers: A Three Year Investigation</i> Presented by Marilyn Sass-Lehrer, Karen Clark, Nicole Hutchinson, Arlene Stredler Brown, Mary Pat Moeller		
Room - International Ballroom D on M2		
<i>Pediatric Audiology Facilities: A Tool to Identify Facilities Equipped to Meet Pediatric Service Needs</i> Presented by Brandt Culpepper, Alan Diefendorf, Winnie Chung, Robert Fifer, Jackson Roush		



2:00 PM - 3:00 PM	Topical Session 2 (Continued)	
	Room - International Ballroom C on M2	
	<i>Using Program Evaluation to Improve the Iowa EHDI system</i> Presented by Tammy O’Hollearn, Jennifer Thorud	
	Room - International Ballroom B on M2	
	<i>Engaging Child Health Providers in EHDI: Connecticut’s EPIC Program</i> Presented by Lisa Honigfeld, Ann Gionet, Brenda Balch, Sarah Schlegel	
	Room - International Ballroom A on M2	
	<i>Mandatory Reporting and Sharing of Information - Even When It Isn’t Mandated</i> Presented by Nancy Kisler, Ginger Mullin, Kathleen Watts	
	Room - Dogwood A on M1	
	<i>Field of Dreams: Building, Believing and Achieving for Infants and Children with Hearing Loss</i> Presented by Meredith Gatzemeyer	
	Room - Dogwood B on M1	
	<i>Audiology 101 – Introduction to Audiology for Non-Audiologists</i> Presented by Terry Foust, Jeff Hoffman	
	Room - Redwood on M1	
	<i>TeleIntervention: A Model Program of Service Delivery</i> Presented by Diane Behl, Todd Houston	
	Room - Juniper on M2	
	<i>Understanding Auditory Neuropathy: Diagnosis and Management</i> Presented by Patricia Roush	
	Room - Walnut on M3	
	<i>Guidelines and Protocols for Testing Children with High Risk Factors</i> Presented by Jana Ziegberman, Marcy Chant	
	Room - Hickory on M3	
	<i>Making Your Case- How to Influence EHDI Public Policy</i> Presented by Mary Hartnett	
	Room - Hazelnut on M3	
	<i>Parent Panel: Our Journey to Today and Our Wish for Tomorrow</i> Presented by Carianne Muse	
3:00 PM - 3:20 PM	Refreshment Break	Grand Ballroom on M4 and Pre-Function Lobbies on M2
3:20 PM - 3:50 PM	Topical Session 3	
	Room - Magnolia on M2	
	<i>Unilateral Hearing Loss Program & Curriculum (0-3yrs): From Conceptualizing & Piloting, to District-Wide Implementation</i> Presented by Natasha Wen	
	Room - International Ballroom E on M2	
	<i>Follow-up in the Medical Home: Findings from New York Primary Care Providers Survey</i> Presented by Jack Levine, Brenda Knudson Chouffi	



3:20 PM - 3:50 PM	Topical Session 3 (Continued)	
	Room - International Ballroom D on M2	
	<i>Infant Hearing Decisions: A DVD Tool for Families</i> Presented by Patti Martin, Nannette Nicholson, Meghan Powell, Alan VanBiervliet, David Weekley, M. Joshua Spann	
	Room - International Ballroom C on M2	
	<i>The Role of Alabama’s CSHCN Agency in Supporting EHDI & Intervention Beyond EHDI</i> Presented by Alice Sette	
	Room - International Ballroom B on M2	
	<i>Utilizing Local Public Health: Closing the Gap in EHDI Follow-up</i> Presented by Nicole Brown, Kirsten Coverstone	
	Room - International Ballroom A on M2	
	<i>Early Childhood Center Based Programs and the NAEYC: How does it work together?</i> Presented by Madelyn Warnock	
	Room - Dogwood A on M1	
	<i>Scripting the Message in 2011 for the One, Three, Six Goals</i> Presented by Sarah Stone, Janet Farrell, Tracy Osbahr	
	Room - Dogwood B on M1	
	<i>Language Outcomes: Results of a Multi-State Collaboration</i> Presented by Allison Sedey, Christine Yoshinaga-Itano	
	Room - Redwood on M1	
	<i>Early Hearing Orientation Visits: Presenting Unbiased and Consistent Information about Early Intervention Services for Deaf/Hard of Hearing Children Across the State of Georgia</i> Presented by Melissa Lawson, Alice Stanley, Sarah Rank	
	Room - Juniper on M2	
	<i>Intervention for Children from Birth to 12 Months Old</i> Presented by Linda Lasker	
	Room - Walnut on M3	
	<i>What’s So Natural About Natural Environment?</i> Presented by Marion Radeen, Ellen Gill, Allison Malerba	
	Room - Hickory on M3	
	<i>Collaborating With Midwives to Screen Out of Hospital Births</i> Presented by Kurt Randall	
	Room - Hazelnut on M3	
	<i>Building Newborn Hearing Screening into State Early Intervention Programs</i> Presented by Candace Adams Grossjohann	
3:50 PM - 4:10 PM	Break	
4:10 PM - 5:10 PM	Plenary II (see abstract on page 30) Moderator: John Eichwald It’s All About the Expectations! Presented by Howard A. Rosenblum	Grand Ballroom on M4



5:10 PM - 5:20 PM	Presentation of the Antonia Brancia Maxon Award for EHDI Excellence	Grand Ballroom on M4
5:45 PM - 7:30 PM	Reception	Grand Ballroom on M4
6:30 PM - 7:30 PM	Entertainment - Manga African Dance Company (see Entertainment on page 7)	Grand Ballroom on M4
7:00 PM - 9:30 PM	AAP Chapter Champion Dinner (By Invitation)	

Tuesday, February 22, 2011

7:15 AM - 8:00 AM	Continental Breakfast	Grand Ballroom on M4
7:15 AM - 12:00 PM	Registration Open	Grand Ballroom Lobby on M4
7:15 AM - 2:30 PM	Open Time to Visit Exhibits	Grand Ballroom on M4
7:15 AM - 3:15 PM	Speaker Ready Room Open	Cypress on M2
8:00 AM - 9:00 AM	Plenary III (see abstract on page 31) Moderator: Brad Golner The Medical Home and EHDI Presented by Albert Mehl	Grand Ballroom on M4
9:00 AM - 9:20 AM	Presentation of Poster and Website Awards	Grand Ballroom on M4
9:20 AM - 9:35 AM	Refreshment Break	Grand Ballroom on M4 and Pre-Function Lobbies on M2
9:35 AM - 10:35 AM	Topical Session 4	

Room - Magnolia on M2

The Nebraska EHDI Data System and Follow-up
Presented by Jeff Hoffman, Jim Beavers

Tracking Child Outcomes Statewide: Integrating Data in the EHDI System
Presented by Vickie Thomson, Dinah Beams

Room - International Ballroom E on M2

The Building Blocks of a Medical Home for Children with Hearing Loss
Presented by Alan Grimes, Debra Waldron, Vicki Hunting

Room - International Ballroom D on M2

Collaborating to Enhance Services for Children with Complex Needs
Presented by Debra Cushner, Brenda Perrodin

Children Labeled Medically Complex Enrolled in Early Intervention
Presented by Susan Wiley, Jareen Meinzen-Derr, Daniel Choo

Room - International Ballroom C on M2

Creating a Program of Family Focused, Web-based Resources
Presented by Terrell Clark, Betsy Kammerer, Garland Waller, Greg Licameli

Social Media and Family Support in EHDI
Presented by Katie Dagenais

Room - International Ballroom B on M2

The Waiting Period: Strategies for Parents as they Prepare their Child for Cochlear Implants
Presented by Carissa Moeggenberg

Helping Families Achieve the Best Outcome for their Child with a Cochlear Implant
Presented by Donna Sorkin, Melissa Wilson



9:35 AM - 10:35 AM

Topical Session 4 (Continued)

Room - International Ballroom A on M2

Anatomy of a First Home Visit

Presented by Sara Kennedy, Denise Davis-Pedrie

Current Trends in Early Intervention Service Provision in North Carolina

Presented by Joni Alberg, Aneesha Pretto

Room - Dogwood A on M1

Importance of Deaf Mentors in EHDI Programs

Presented by Debra Patkin

Jump Start Your ASL

Presented by David Reynolds, Tami Hossler

Room - Dogwood B on M1

A View from the 'Finish' Line: The Impact of Early Detection and Early Intervention on Literacy Outcomes

Presented by Mary Ellen Nevins, Melissa McDonald

Early Intervention's Long Term Language Planning Impact

Presented by David Geeslin

Room - Redwood on M1

Advocacy for Children Using the Individuals with Disabilities Education Act

Presented by Barbara Raimondo

Growing Parent Leaders

Presented by Kat Lowrance, Cora Shahid

Room - Juniper on M2

Innovations in Early Intervention: Restructuring a Statewide Program

Presented by Day Mullings, Jennifer Howell

Building Powerful Graphic Displays to Discover and Convey EHDI Information

Presented by Stevenson Richardson, Craig Mason, Brian Armour, Winnie Chung, Michelle Sloan

Room - Walnut on M3

Fast Mapping and Word Learning in Noise

Presented by Kristina Blaiser, Kathryn Kohnert, Peggy Nelson

Current Practices of FM Use in Preschool Children with Hearing Loss

Presented by Karen Munoz, Lauri Nelson, Bridget Poole

Room - Hickory on M3

Pediatric Specialty Certification and NCHAM

Presented by Karen Ditty, Diane Sabo

Writing Reports That Everyone Can Understand

Presented by Les Schmeltz, Karen Ditty



9:35 AM - 10:35 AM	Topical Session 4 (Continued)
	<p>Room - Hazelnut on M3</p> <p><i>Experiencing Deaf Culture: Creating a Friendly Visual Environment at Home</i> Presented by Nancy Kelly-Jones</p>
10:35 AM - 10:50 AM	Break
10:50 AM - 11:50 AM	Topical Session 5
	<p>Room - Magnolia on M2</p> <p><i>Intervention Options: Informed Parents Rely on Informed Professionals</i> Presented by Ellen Estes</p> <p><i>Creating an Optimal Preschool Environment for Listening and Spoken Language Development</i> Presented by Corine Theobald, Janet Felice</p>
	<p>Room - International Ballroom E on M2</p> <p><i>Colorado Audiology LEND Tele-health/Tele-education Project</i> Presented by Vickie Thomson, Sandra Gabbard, Shannon Burns, Stacy Claycomb, Kristin Uhler, Chandace Jeep</p> <p><i>Teleaudiology: The Key to Serving Rural Populations</i> Presented by Elizabeth Seeliger, Cindy Grant-See</p>
	<p>Room - International Ballroom D on M2</p> <p><i>Impacting Loss to Follow-up: Utilizing Parent Support Organizations to Enhance EHDI Collaborative</i> Presented by Brigitte Dufour, Jeanne Hollabaugh, Valerie Odeh</p> <p><i>Empowering Families through a Hands & Voices Guide By Your Side (GBYS) and Early Hearing Detection & Intervention (EHDI) Collaboration</i> Presented by Lisa Kovacs, Gayla Hutsell-Guignard</p>
	<p>Room - International Ballroom C on M2</p> <p><i>Challenges In Obtaining An Infant Diagnostic Hearing Evaluation: The parent perspective</i> Presented by Karen Munoz, Lauri Nelson, Janet DesGeorges, Rebecca Larsen</p> <p>TBD Presented by TBD</p>
	<p>Room - International Ballroom B on M2</p> <p><i>Clarifying Cued Speech: A Discussion about the Myths, Facts, and Research around Cued Speech</i> Presented by Amy Ruberl</p> <p><i>Communicating about Communication Options</i> Presented by Cathy Quenin</p>
	<p>Room - International Ballroom A on M2</p> <p><i>Guidelines for Transitioning Applied with Young, Deaf Children Following Cochlear Implantation</i> Presented by Terrell Clark</p> <p><i>Cochlear Implantation and Knowledge Needs of Early Intervention Professionals</i> Presented by Donna Sorkin</p>



10:50 AM - 11:50 AM	Topical Session 5 (Continued)	
	<p>Room - Dogwood A on M1</p> <p><i>Key to Success: Parental Involvement in Language Acquisition</i> Presented by Debra Patkin</p> <p><i>Ensuring Language Acquisition: ASL and English</i> Presented by Debra Patkin</p>	
	<p>Room - Dogwood B on M1</p> <p><i>Building Capacity of Early Intervention Providers</i> Presented by Jodee Crace, Cindy Lawrence</p> <p><i>Interdisciplinary Programming for Early Intervention Specialists: One University's Experience</i> Presented by Marilyn Sass-Lehrer, Julie Mitchiner, Wendy Hanks, Nicole Hutchinson, Brenda Seal</p>	
	<p>Room - Redwood on M1</p> <p><i>Improving Access: An Out of Hospital Birth Project</i> Presented by Gretchen Spicer, Megan O'Hern</p> <p><i>Thinking Outside the Hospital: Tips for Midwife Centers and Home Births</i> Presented by Mary Jane Sullivan</p>	
	<p>Room - Juniper on M2</p> <p><i>Which Comes First: The Chicken or the Egg?</i> Presented by Sara Kennedy, Denise Davis-Pedrie</p> <p><i>Pragmatic Language Development of Children with Hearing Loss</i> Presented by Christine Yoshinaga-Itano, Rosalinda Baca, Molly Dalpes, Amanda Abrisch, Dianne Goberis</p>	
	<p>Room - Walnut on M3</p> <p><i>Improving Lost to Follow-up: Meeting Families Where They Are At</i> Presented by Lori Wiorek</p> <p><i>Powerful EHDI Community Partnerships</i> Presented by Barb Dalbec, Kirsten Coverstone, Candace Lindow Davies, Curt Leitz</p>	
	<p>Room - Hickory on M3</p> <p><i>360 Degree Quality Assurance in Early Intervention: An Imperative</i> Presented by Claudine Storbeck, Paula Pittman</p> <p><i>What We Have Learned About Home Visits in Two Countries: Insights from Early Interventionists</i> Presented by Paula Pittman, Claudine Storbeck</p>	
	<p>Room - Hazelnut on M3</p> <p><i>EHDI International Activities</i> Presented by Claudia Gaffney</p>	
11:50 AM - 1:45 PM	Lunch (on your own)	
12:15 PM - 1:30 PM	Students Involved in EHDI Lunch	International Ballroom D on M2
12:15 PM - 1:30 PM	AAP Chapter Champion Working Lunch	Dogwood A on M1



12:15 PM - 1:30 PM

Our Town Lunch and Discussion

Tables in Grand Ballroom
Lobby area on M4

1:45 PM - 2:45 PM

Topical Session 6

Room - Magnolia on M2

Systems Jigsaw: Providing Deaf/Hard of Hearing Specific Family-Focused Services within a State Systems' Context

Presented by Karen Clark, Cindy Lawrence, Claire Sullivan

Room - International Ballroom E on M2

Using Teleconferences to Keep UNHS Stakeholders Connected... The Texas Experience

Presented by Mary Catherine Hess, Sarah Shaw, Mary Gywn Allen

Room - International Ballroom D on M2

Coordinated Referral Process for Intervention for Children of All Ages

Presented by Marcia Fort, Mandy Hice, Rachael Ragin

Room - International Ballroom C on M2

The Medically Complex Infant: Achieving "6" in the NICU

Presented by Kelly Baroch

Room - International Ballroom B on M2

What Doesn't Stay in Vegas (Parent Distance Ed)

Presented by Anne McNally, Jill Muhs

Room - International Ballroom A on M2

An Innovative Process Improvement Tool for EHDI Programs – Hospital Site Visits

Presented by Tammy O'Hollearn

Room - Dogwood A on M1

Entendiendo. Understanding Hispanic/Latino Families with DHH children

Presented by Rachel Friedman Narr, Irma Sanchez

Room - Dogwood B on M1

Integrated Data Systems: Successes and Challenges in the Indiana EHDI Program

Presented by Julie Schulte, Gayla Hutsell-Guignard, Ben Klopfer

Room - Redwood on M1

Outcomes of Children with Mild to Severe Hearing Loss

Presented by Mary Pat Moeller, Shana Jacobs, Melody Harrison, Patricia Roush, Thomas Page, Lenore Holte, Bruce Tomblin, Ruth Bentler

Room - Juniper on M2

Unilateral Hearing Loss Caused by CMV

Presented by Faye McCollister, Karen Fowler

Room - Walnut on M3

Infant Hearing Aid Practices and Experiences in Utah

Presented by Karen Munoz, Richard Harward, Day Mullings

Room - Hickory on M3

Prevention of Child Abuse & Neglect Through the Provision of Effective Early Intervention Services

Presented by Harold Johnson



1:45 PM - 2:45 PM	Topical Session 6 (Continued)
	Room - Hazelnut on M3
	<i>Cued Speech for Parents</i> Presented by Cathy Quenin & Amy Ruberl
2:45 PM - 3:00 PM	Poster and Exhibitor Break-down begins
2:45 PM - 3:00 PM	Refreshment Break Grand Ballroom on M4 and Pre-Function Lobbies on M2
3:00 PM - 3:30 PM	Topical Session 7
	Room - Magnolia on M2
	<i>Trekking to the Top: A Family Camp Conference</i> Presented by Patti Martin, Nannette Nicholson, Teresa Caraway, Wendy DeMoss, Mandy McClellan, Tori Tedford
	Room - International Ballroom E on M2
	<i>Evaluating and Improving Your Services through Parent Input: Implementing the ‘My View on Services’ Tool</i> Presented by Ginger Mullin, Karen Aguilar
	Room - International Ballroom D on M2
	<i>Identifying Effective Practices to Support Early Linguistic Competence</i> Presented by Debra Nussbaum, Beth Benedict
	Room - International Ballroom C on M2
	TBD TBD
	Room - International Ballroom B on M2
	<i>EduBaby Marshall Islands: A Trans-Pacific Partnership</i> Presented by Mellanie Lee, Jan Fried, Nancy Rushmer, Katina Peter, Judy Coryell
	Room - International Ballroom A on M2
	<i>The Newborn Hearing Screening Training Curriculum: A Preview of Upcoming Changes</i> Presented by Randi Winston, Karen Ditty
	Room - Dogwood A on M1
	<i>Screening/Audiology Facilities at the Tip of Your Finger to Benefit Families and State Systems</i> Presented by Winnie Chung
	Room - Dogwood B on M1
	<i>Establishing ENT Guidelines for Infants Diagnosed with Hearing Loss</i> Presented by Lorie Lang, Colleen Barry
	Room - Redwood on M1
	<i>Survivor’s Tips to Avoid EHDI Burnout</i> Presented by Vickie Thomson, Hallie Morrow, Lylis Olsen, Nancy Pajak, Jacque Cundall
	Room - Juniper on M2
	<i>Adding the Missing Link to Language Assessment of Children with Hearing Loss: Language Environment Analysis</i> Presented by Christine Yoshinaga-Itano, Jill Gilkerson, Rosalinda Baca, Mallene Wiggins



3:00 PM - 3:30 PM	Topical Session 7 (Continued) Room - Walnut on M3 <i>Building Listening and Spoken Language: It's a 'Piece of Cake'</i> Presented by Jennifer Wallace, Alison Tucker	
	Room - Hickory on M3 <i>Baha Softband Case Studies: Managing Conductive and/or Mixed Hearing Loss in Craniofacial Abnormalities and Syndromic Hearing Loss</i> Presented by George Cire	
	Room - Hazelnut on M3 TBD TBD	
3:30 PM - 3:45 PM	Break	
3:45 PM - 4:45 PM	Closing Plenary (see abstract on page 32) Moderator: Karl White EHDI & Family Support: Past, Present and Future (Hands & Voices Panel)	Grand Ballroom on M4





OPENING PLENARY

MONDAY, FEBRUARY 21

8:15 AM–9:15 AM

GRAND BALLROOM on M4

Ten Years of EHDI

The first official Early Hearing Detection and Intervention (EHDI) meeting was held February 11-13, 2002 at Tysons Corner in Vienna, Virginia. Since that time, significant progress has been demonstrated in identifying and providing early intervention services to deaf and hard-of-hearing infants. Data reported in 2002 (for calendar year 2000) estimated that slightly more than half of all newborns in the United States were screened for hearing loss. A decade later more than 95% of U.S. infants can be documented as having their hearing screened. However, several challenges remain such as ensuring timely diagnostic evaluation for those who do not pass the screening, enrollment in early intervention for those with diagnosed hearing loss, and the provision of culturally appropriate support services for those families. The opening plenary session of this ten-year anniversary will feature representatives of the co-sponsors of the meeting, the American Academy of Pediatrics (AAP), the Centers for Disease Control and Prevention (CDC), the Health Resources and Services Administration (HRSA) and the National Center for Hearing Assessment and Management (NCHAM). Each representative will reflect on their national perspectives of where EHDI has been and what may lie ahead in the future for improving early hearing screening, diagnosis, and intervention systems for infants/young children and their families.



Bonnie Strickland

Director, Division of Children with Special Health Needs
Maternal and Child Health Bureau

Dr. Strickland is the Director of the Division of Services for Children with Special Healthcare Needs (DSCSHN) in the Health Resources and Services Administration's (HRSA) Maternal and Child Health Bureau on (MCHB). Dr. Strickland administers a national system of programs designed to improve genetic services including a specific focus on Sickle Cell Disease and Hemophilia; as well as condition-specific initiatives in Autism Spectrum Disorders (ASD); Traumatic Brain Injury; Early Hearing Detection and Intervention; and Access to Care for Children and Youth with Epilepsy. She holds a Doctorate in Early Childhood Education from the University of North Carolina at Chapel Hill.

John Eichwald

Centers for Disease Control and Prevention (CDC)
U.S. Department of Health and Human Services

John Eichwald is the Team Lead for the Early Hearing Detection and Intervention (EHDI) Program within the National Center on Birth Defects and Developmental Disabilities at the Centers for Disease Control and Prevention in Atlanta, Georgia. In this position he oversees various EHDI activities including collaboration with federal, national, and state agencies and organizations in assisting states and territories to develop standardized procedures for newborn hearing screening tracking, surveillance, data collection and management.

Louis Cooper, MD, FAAP

Past President of the American Academy of Pediatrics (2001-2002)

Dr. Cooper has served on numerous advisory bodies at the federal, state, and city level in New York, including chairmanships of the Medical Society of the State of New York Committee on Medicaid, and the Public Policy Committee (PPC) of the Pediatric Infectious Disease Society. Dr. Cooper was also the founding Co-Chairman of the Campaign for Healthy Children, best known for designing, advocating, and facilitating implementation of the Child Health Plus Program, New York's effort to guarantee health insurance for every child in the state. He continues to stay involved with a number of AAP initiatives including serving on the AAP Task Force on Improving the Effectiveness of Newborn Hearing Screening, Diagnosis, and Intervention.

Karl White

National Center for Hearing Assessment and Management
(NCHAM)
Utah State University

Dr. White is a Professor of Psychology at Utah State University and the founding Director of the National Center for Hearing Assessment and Management (NCHAM). Prior to his work at NCHAM, he was the Director of Research and Development at the National Technical Institute for the Deaf, and from 1984 to 1985, he served as a Congressional Science Fellow with the American Association for the Advancement of Science and worked as a staff member for the Subcommittee on the Handicapped in the United States Senate where he was responsible for the staff work related to the creation of the Commission on Education of the Deaf and the Education of the Deaf Act of 1986.



PLENARY SESSION II

MONDAY, FEBRUARY 21

4:10 PM-5:10 PM

GRAND BALLROOM on M4

It's All About the Expectations!

This presentation consists of a combination of background information on laws and rights for parents and children with a very revealing look at the lives of deaf children who are now adults. Using a picture of his own class when he was in the second grade, Mr. Rosenblum will present a fascinating 'where are they now' discussion about each child. This very personal discussion draws people in, and gives a huge surprise at the end when people realize the children that have grown up with Mr. Rosenblum.



Howard A. Rosenblum

National Association of the Deaf

Midwest Center on Law and the Deaf

Equip for Equality

Howard A. Rosenblum is a Senior Attorney at Equip for Equality, a nonprofit organization designated as Illinois' Protection and Advocacy entity. He has been an attorney for eighteen years, ten of which were in private practice with Monahan & Cohen. He will begin as the Chief Executive Officer of the National Association of the Deaf (NAD) in April 2011. Mr. Rosenblum has focused his legal practice in the areas of disability rights and special education. Having been profoundly deaf since age 2, he is a product of special education and seeks to improve the system. He is also the founder and board chair of the Midwest Center on Law and the Deaf (MCLD), which is dedicated to ensuring that deaf and hard of hearing people have full and equal access to lawyers and the courts. Mr. Rosenblum received his law degree from IIT Chicago-Kent College of Law (1992), and his Bachelor of Science degree in Computer Engineering from the University of Arizona (1988).





PLENARY SESSION III

TUESDAY, FEBRUARY 22

8:00 AM–9:00 AM

GRAND BALLROOM on M4

The Medical Home and EHDI

In recent years, the concept of a ‘medical home’ has been recognized as especially important in providing appropriate care for children with special needs and their families. The characteristics of a ‘medical home’ are outlined, with attention to how one can link lofty and descriptive ideas with concrete actions and measurable outcomes. A special emphasis on a ‘Just-In-Time’ learning model is highlighted in the area of early hearing detection and early intervention.



Albert Mehl, MD, FAAP

Chairperson, American Academy of Pediatrics (AAP) Task Force on Improving Hearing Screening, Diagnosis and Intervention

Dr. Albert Mehl has been a pioneer in newborn hearing screening since 1992 when he agreed to help implement a newborn hearing screening program at Boulder Community Hospital. He was instrumental in getting Colorado’s newborn hearing legislation passed in 1997 when he used his experience as a pediatrician to convince legislators that newborn hearing screening was the right thing to do for all children. He continues to provide pediatric medical care in Lafayette, Colorado, serves as the Chairperson for the AAP Task Force on Improving the Effectiveness of Newborn Hearing Screening, Diagnosis, and Intervention, and is the AAP representative to the Joint Committee on Infant Hearing (JCIH). At the 2010 National EHDI Conference he received the Maxon Award for EHDI Excellence. As a primary care physician, Dr. Mehl has successfully implemented the medical home concept in his own practice using a team approach with the audiologist, Hands & Voices parent guide and early interventionist working together for the benefit of the child and the family.

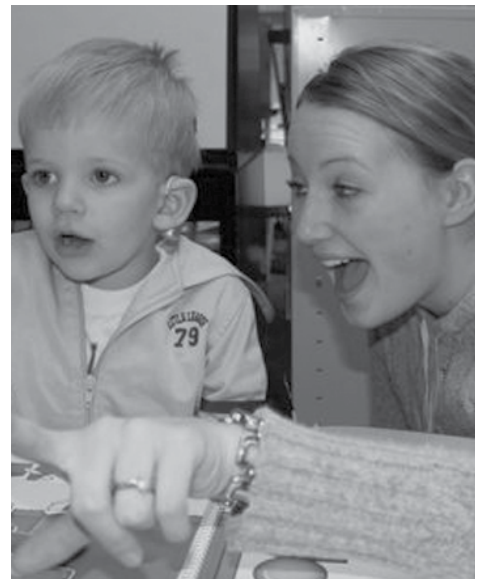



CLOSING PLENARY

TUESDAY, FEBRUARY 22

3:45 PM–4:45 PM

GRAND BALLROOM on M4

EHDI & Family Support: Past, Present and Future

Family support in the EHDI system has grown from an undefined element to a structured, embedded component of programs that recognize the value and necessity of formalized systemic family support. This session will be delivered from three distinct viewpoints from the ranks of Hands & Voices (H&V) – three parent leaders who represent past, present and future experiences will share thoughtful, relevant insights into this theme. Starting with Janet DesGeorges who was one of the first parent consultants to EHDI systems, the origins of EHDI family support will be explored. Then Curt Leitz, who is a Minnesota H&V Guide By Your Side (GBYS) Parent Guide will share his current perspective on direct parent-to-parent support via GBYS programs, followed by Maria Rodriguez, a Colorado H&V Latina Parent Guide who will share her vision for the diversity, customizable flexibility and expansiveness of parent support programs of the future.



Janet DesGeorges

Hands & Voices

Colorado Families for Hands & Voices

Janet DesGeorges lives in Boulder, Colorado with her husband Joe and is mom to three daughters, including Sara, who is hard of hearing. She is the Executive Director of Colorado Families for Hands & Voices, and is a co-founder and part of the national staff at Hands & Voices, Inc. as the Outreach Director. Janet has presented to groups nationwide and internationally about the experiences of families as they journey through life with a child with deafness or hearing loss. Ms. DesGeorges is the co-author of a chapter on Educational Law for Deaf/HH students, a contributing author to the NCHAM e-book, and many other publications. She currently serves on the national faculty for the NICHQ EHDI Learning Collaborative, as well as the Marion Downs Center Advisory, and co-chairs the CDC Parent-to-Parent Committee.

Curt Leitz

Minnesota Hands & Voices

Northeast Minnesota Parent Guide

Curt Leitz is the father of a girl whose hearing loss was identified at age two; since then, he and his family have navigated support systems in three different states. Since 2007 he has worked as the Northeast Minnesota Parent Guide for Minnesota Hands & Voices, where his focus is direct parent-to-parent support and one of his keen interests is engaging fathers in their children's support.

Maria Rodriguez

Colorado Families for Hands & Voices

Maria was born in Mexico but raised in Denver, Colorado since she was 9 years old. She is married and her spouse is non-English speaking. They have a six year old daughter who has a bilateral profound hearing loss and has a cochlear implant. They currently live in Denver, Colorado where Maria works as a Spanish Speaking Parent Guide for Hand & Voices of Colorado.





Posters/Exhibits



Poster Session Layout

EARLY HEARING DETECTION INTERVENTION POSTER SESSION
 FEBRUARY 21-22, 2011

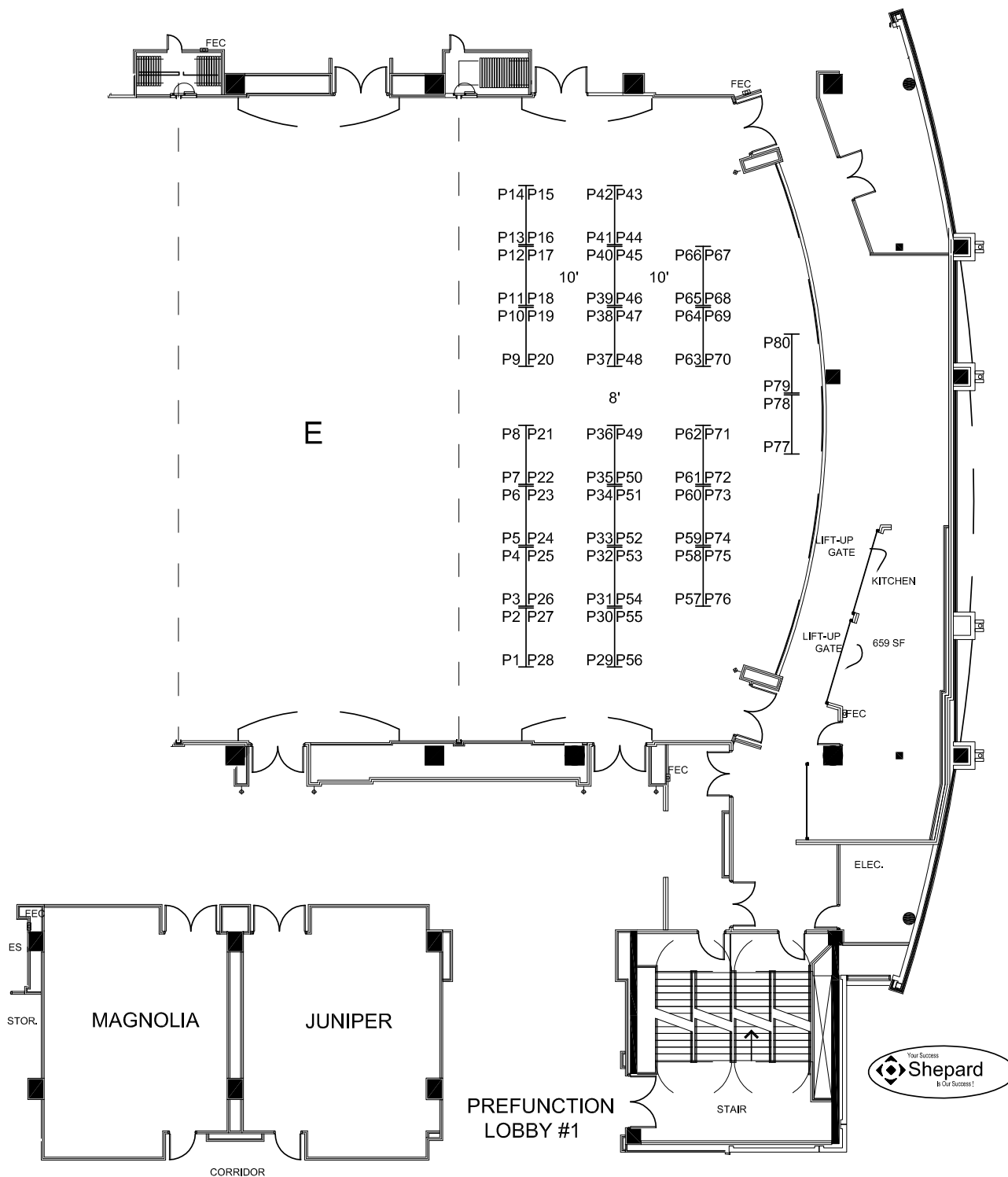

OMNI CNN HOTEL ATLANTA
 INTERNATIONAL BALLROOM F, NORTH TOWER





POSTER PRESENTATIONS

INTERNATIONAL BALLROOM F on M2

Posters will be available for viewing throughout the conference, and poster presenters will be on hand during the poster session time listed below.

Poster Session
Monday, February 21
12:45 PM–1:45 PM

Poster Awards
A panel of judges will evaluate the posters based on abstract reviews and effective design. Blue ribbons placed on the posters will identify the winners.

Poster Awards Presentation
Tuesday, February 22
9:00 AM
Grand Ballroom on M4
(following Plenary Session III)

P-1

Networking opportunities for EHDI stakeholders: CDC-EHDI Committees
Presented by Stevenson Richardson, Claudia Gaffney, Alicia Curry

P-2

Overcoming the Distance: EHDI Service Delivery in Remote Alaska
Presented by Samantha Kleindienst, Stephanie Karch, Steve Robert

P-3

A Multi-Agency Partnership to Improve Washington's EHDI Process from Birth to Early Intervention
Presented by Karin Neidt

P-4

Is Pre-Service Training of Pediatric Audiologists Working? Show Me the Data!
Presented by Wendy Hanks, Carol LaSasso, Steve Ackley

P-5

What's up with Telehealth within the EHDI system?
Presented by Diane Behl

P-6

Pediatric Hearing Aid Coverage: State of the States
Presented by Angelique Boerst

P-7

Identifying the variables that lead to poorer outcomes in our Spanish speaking population: Can we level the playing field?
Presented by Sandra Gabbard, Shannon Burns, Kristin Uhler

P-8

It Takes a Team: Collaborating to meet the special needs of children with multiple challenges.
Presented by Barbara Hecht, Elisa Roche

P-9

Simultaneous Cochlear Implant Rehabilitation: New Issues in Mapping
Presented by Kristin Dilaj, Diane Brackett, Kendra Blok

P-10

Tests for Transition: Evidence Supporting B23 Recommendations
Presented by Kristin Dilaj, Diane Brackett, Kendra Blok

P-11

Natural Environments for Infants and Toddlers Who are Deaf or Hard of Hearing and Their Families: ASHA-CED Joint Committee Fact Sheet
Presented by Nancy Grosz Sager, Marilyn Sass-Lehrer

P-12

The Effects of Maternal Stress and Child Language Ability on Behavioral Outcomes of Children with Congenital HL
Presented by Nicole Girard, Betty Vohr

P-13

Sound Beginnings: Coaching Families with LENA Feedback
Presented by Lindsay Rodriguez, Helen Morrison, Lisa Lopez

P-14

STARR: 5 Points to Success
Presented by Lindsay Rodriguez, Lisa Lopez

P-15

Spoken English Services within an ASL Environment: Making it Work
Presented by Sarah Fairbanks, Patricia Timm

P-16

Linking to Services and Reflective Data for Infants with a Hearing Loss in Illinois
Presented by Ginger Mullin, Sheila McCurley, Benjamin Layne

P-17

Community Correlates to Meeting 1-3-6
Presented by Ginger Mullin, Sheila McCurley, Meredith Volle

P-18

Where are Those Babies?
Presented by Ginger Mullin, Sheila McCurley, Meghan Calandro

P-19

Can Refer Rates Be Too High or Too Low? Assessing Illinois
Presented by Ginger Mullin, Sheila McCurley, Meredith Volle, Meghan Calandro, Benjamin Layne

P-20

"What Gets Measured, Gets Changed": A Shared Accountability Model for Hospital Screening Programs
Presented by Brigitte Dufour, Sondi Aponte



P-21

Newborn Hearing Screening: Keeping Refer Rates Low
Presented by Margaret Toro

P-22

Reducing Loss to Documentation: Improving Reporting to EHDl Programs by Audiologists
Presented by Erika Blanchard

P-23

Utilizing a Home Visiting Health Nurse as a Strategy for Improving Follow-up After Hospital Discharge
Presented by Randi Winston

P-24

Public Awareness & Steps to Improve Lost to Follow Up
Presented by Angie Mister

P-25

Understanding Why Infants are not Completing the Hearing Screening Process
Presented by Elizabeth Abbey

P-26

A Case for Outpatient ALGO Re-Screening
Presented by Barbara Morris

P-27

Auditory Neuropathy/Auditory Dys-synchrony
Presented by Cathrine Hayes, Linsey Watkins, Mary Edwards, Lauren Bolek, Andrea Hedley-Williams, Linda Hood

P-28

Diagnosed Hearing Loss: A Retrospective Look at Risk Factors
Presented by Julie Schulte, Gayla Hutsell-Guignard

P-29

Diagnostic ABR in Infants: Costs, Benefits, and Outcomes Using Sedated and Non-Sedated Procedures
Presented by Brittany Richardson, Patricia Roush, Jackson Roush

P-30

Improving Outcomes of Hearing Screening in the Neonatal Intensive Care Unit (NICU)
Presented by Kate Bowman, Karen Munoz, Shana Jacobs, Jackson Roush

P-31

Children with Early Hearing Loss and Existing Comorbid Health Conditions in New Jersey: State Data and the Experience of Families
Presented by Deborah M. Spitalnik, Caroline Coffield, Kathy Roberson, Leslie Beres-Sochka, Kathryn P. Aveni, Nancy Schneider, Linda Biando

P-32

Late onset hearing loss in NICU infants
Presented by Lynn Iwamoto

P-33

Children's Hearing Clinic: Identifying Etiology and Offering Family Support
Presented by Deborah Hayes

P-34

Grief and Family Involvement
Presented by K. Todd Houston, Kristina Blaiser, Molly Moosman, Elizabeth Doughty

P-35

Family Weekend Conference: Empowering Parents
Presented by Patti Martin, Nannette Nicholson, Kathy Shapley, Rebekah Talkington, Mandy McClellan, Meghan Powell

P-36

Parent to Parent Newborn Hearing Notebook
Presented by Tonya Bowman, Camille Keck

P-37

A low-cost exon capture method suitable for large-scale screening of genetic mutations in deafness genes by the massively-parallel sequencing approach
Presented by Xi Lin

P-38

Diagnosis of Congenital Cytomegalovirus (CMV) and Laboratory Testing for CMV Infection among Infants in the United States
Presented by Jessica Leung, Michael Cannon, Riduan Joesoef, Scott Grosse, Stephanie Bialek

P-39

Attitudes towards Newborn Screening for Cytomegalovirus Infection, Health Styles 2009
Presented by Michael Cannon, Erica Din, Cedric Brown, Scott Grosse, Chengbin Wang, Stephanie Bialek, Danielle Ross

P-40

Cochlear implantation in children with multiple disabilities
Presented by Jolie Fainberg

P-41

Child Can Have More Choices: Reflections of Deaf Mothers on Cochlear Implants for their Children
Presented by Julie Mitchiner

P-42

Cochlear Implant Training: Intervention for the Early Interventionist
Presented by Cache Pitt, Liz Hankins

P-43

A Case-Study Probe of Relationship-Based Intervention as a Point of Entry with Families of Infants with Hearing Loss
Presented by Marian Hartblay



P-44

The University of Pittsburgh UCLID Center: An interdisciplinary collaboration

Presented by Megan Cahill, Katherine Monahan, Diane Sabo, Sarah Sohns

P-45

Feasibility Study of Using Narrative Analysis System for Preschool Children With Hearing Loss

Presented by Abbie Olszewski, Kristina Blaiser

P-46

Young Children's Attitudes Towards Their Peers Who Wear Hearing Aids

Presented by Lindsey Rentmeester, Anne Marie Tharpe

P-47

Baby Signing: Explosion, Empirical Research, and Implications for EHDI Programming

Presented by Michelle Brown, Ye-Kyung An, Alison Gannon, Brenda Seal

P-48

Cochlear Implants for Children with Hearing Loss and Additional Disabilities

Presented by Elizabeth Boschini

P-49

Parents Perspectives on the Physician's Role in Parent Support When a Child is Diagnosed with Hearing Loss

Presented by Maria Roetto, Karen Muñoz



Exhibit Hall Layout

EARLY HEARING DETECTION INTERVENTION FEBRUARY 21-22, 2011

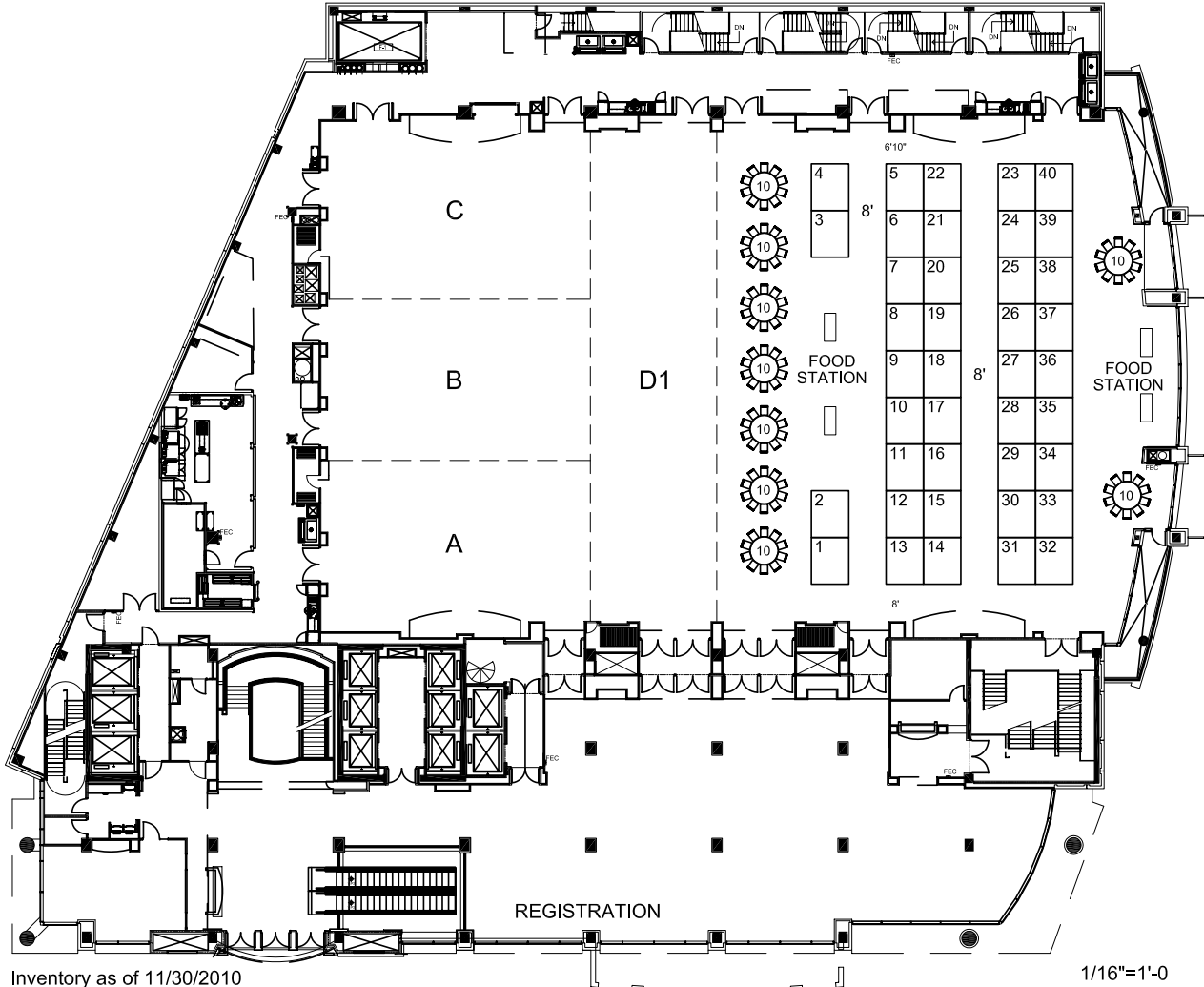

Inventory as of 11/30/2010

Dimension	Size	Qty	SqFt
8'x10'	80	40	3,200
Totals:		40	3,200

OMNI CNN HOTEL ATLANTA
GRAND BALLROOM LEVEL: D-E
NORTH TOWER

1/16"=1'-0





EXHIBITS

EXHIBITS

GRAND BALLROOM

The 2011 EHDI Conference Planning Committee would like to express their appreciation to all of the following exhibitors for supporting the EHDI Conference.

**Special thanks to the following exhibitors for sponsoring lunch on Monday*

Exhibits will be open:

Monday, February 21
7:15 AM–7:30 PM

Tuesday, February 22
7:15 AM–2:30 PM

Booth	Exhibitor Name	Website
1	Oticon	www.oticonusa.com/children
* 2	HiTrack	www.hitrack.org
3	MED-EL Corporation	www.medel.com
4	ECHO Initiative	www.kidshearing.org
5	Centers for Disease Control and Prevention (CDC)/NCBDDD	www.cdc.gov/ncbddd/index.html
6	Vivosonic Inc.	www.vivosonic.com
7	American Society for Deaf Children	www.deafchildren.org
8	American Academy of Pediatrics	www.aap.org
9	Cochlear	www.cochlearamericans.com
10	Intelligent Hearing Systems	www.ihsys.com
* 11	Phonak	www.phonak-us.com
12	Educational Audiology Association	www.edaud.org
13	Natus Medical Incorporated	www.natus.com
14	ASL Tales	www.ASLTales.net
15	Otodynamics Ltd.	www.otodynamics.com
16	BEGINNINGS	www.ncbegin.org
17	Georgia Relay	www.georgiarelay.org
* 18	National Center for Hearing Assessment and Management (NCHAM)	www.infanthearing.org
19	Auditory-Verbal Center	www.avchears.org
20	Texas Dept. of State Health Services	http://deafed-childabuse-neglect-col.wiki.educ.msu.edu/
* 21	ASHA	www.asha.org
22	University of Miami Kids Hear Now Cochlear Implant Family Resource Center	http://khnfamilyresourcecenter.org
30	Oral Deaf Education	www.oraldeafed.org
31	Alexander Graham Bell for the Deaf and Hard of Hearing	www.agbell.org
32	Center for Accessible Technology in Sign	www.cats.gatech.edu
33	Maico Diagnostics	www.maico-diagnostics.com
34	Advanced Bionics	www.advancedbionics.com
35	OZ Systems	www.oz-systems.com
36	Hands & Voices	www.handsandvoices.org
37	O.U.R. Children Coalition	http://deafed-childabuse-neglect-col.wiki.educ.msu.edu/
38	Deaf Bilingual Coalition	www.dbcusa.org
39	Grason-Stradler	www.grason-stradler.com
40	National Cued Speech Association	www.cuedspeech.org

Oticon Safari
Natural Sound,
without compromise



Safari pediatric hearing instruments include 3 different models each with 3 price/performance categories, to **support children with any hearing loss from mild to profound and any age group from infant to teen.**

Learn more about Oticon Safari - **the first truly dedicated family of hearing instruments for children of all ages!** Visit www.oticonusa.com



oticon
PEDIATRICS

Paid Advertisement. Information in this advertisement does not reflect any type of endorsement by the EHDI Conference Co-sponsors or Planning Committee.





State Stakeholders' Meeting



State Stakeholders' Meeting

At the 2011 Annual EHDl Conference, time will be provided to help attendees maximize what they learn at the conference and use the new knowledge to improve their state's EHDl system when they return home. One session at the conference will be devoted to collaboration and planning for each state. During the session, attendees from each state will meet together to learn about the goals and priorities for their state's EHDl system and to coordinate attendance at workshops.

Preparing for the EHDl Conference

Prior to the conference, participants are encouraged to reflect on the status of their state's EHDl system and also what they would like to learn from the conference workshops. Conference participants may want to review the following items:

- Individual participants are encouraged to complete the Pre-Conference Individual Reflection and Planning form. The schedule for the conference and abstracts for all of the sessions are available on the conference website. This information may be used during any pre-conference planning meetings or during the State Stakeholders' Meeting session at the conference.
- States may choose to communicate among registered attendees prior to the conference for preliminary planning purposes to discuss state priorities and initiatives.

During the EHDl Conference

- **Monday, February 21, 2011 – 9:45 to 10:35 AM** - The State Stakeholders' meeting may include introductions, defining EHDl priorities in the state/territory, and devising a strategy for the attendees to gain as much information as possible during the conference. Each state group may review the Conference Program Book and decide how to coordinate attendance at sessions so that representatives from the state have the opportunity to attend sessions that are most relevant to priorities for their state. The Team-Up at the EHDl Conference worksheet (page 44) will be provided as a template to help the group ensure that the participants attend sessions with information relevant to their state's priorities.
- **Individual Post-Conference Plan (My To-Do List)** - Each attendee will receive two Individual Post-Conference Plan (My To-Do List) sheets (as shown on page 46) to record some of the most important information that was learned during workshop and plenary sessions on Day 1 and Day 2. The Plan also includes a way for each attendee to record how this information will be used to continue to enhance the state's EHDl system. The plan sheets can be turned in at the Registration Desk at the end of each day's workshops.

Following the EHDl Conference

The Individual Post-Conference Plan (My To-Do List) sheets that are turned in to the Registration Desk will be transcribed and clustered for each state. The Plan sheets for each state will be returned to the EHDl coordinator for that particular state.





Pre-Conference Individual Reflection and Planning

**2011 Early Hearing Detection and Intervention Conference
February 21–22, 2011 | Atlanta, Georgia**

Each year we strive to provide a conference agenda and format that fosters networking, collaboration, and information sharing. The State Stakeholders' Meeting will provide a forum for discussion of priorities in your state. We encourage you to record your answers to the following questions and bring them with you to the State Stakeholders' Meeting session at the 2011 Early Hearing Detection and Intervention (EHDI) Conference.

1. What do you think is the primary priority for EHDI in your state?
2. What are your personal goals in attending this conference?
3. What sessions would you like to attend? (See the full conference schedule online at <http://www.ehdiconference.org>)
Pre-Conference Workshop:
Topical Session 1:
Poster Session:
Topical Session 2:
Topical Session 3:
Topical Session 4:
Topical Session 5:
Topical Session 6:
Topical Session 7:
4. What exhibits or meetings do you plan to attend? Are there special EHDI topics that you are interested in exploring?
5. What connections or contacts would you like to make at the conference?



Team Up at the EHDI Conference

With all of the great sessions and information shared, it's impossible for any one person to take in everything. In light of your State Stakeholders' Meeting discussion and your Pre-conference Individual Reflection and Planning form, we encourage you to take a few minutes to determine which sessions are most relevant to addressing your state's priorities. Please work together to ensure that at least one person from your team attends each 'most relevant' session. This sheet has been provided to assist your team in making a plan so that your group doesn't miss out on vital information.

In addition, the Session Notes and Application forms are provided on pages 54-57 for you to record notes from each session you attend.

Monday, February 21

Sessions	Sessions most relevant to state priorities	Person(s) attending
Topical Session 1		
Poster Session		
Topical Session 2		
Topical Session 3		



TEAM UP AT THE EHDl CONFERENCE (CONTINUED)

Tuesday, February 22

Sessions	Sessions most relevant to state priorities	Person(s) attending
Topical Session 4		
Topical Session 5		
Topical Session 6		
Topical Session 7		



Individual Post-Conference Plan (My "To Do" List)

State _____ Name (optional) _____



Today I learned that...

When I return home, I will...

Today I learned that...

When I return home, I will...



Today I learned that...

When I return home, I will...

Please turn in one copy of your completed worksheet at the Registration Desk at the end of each day's workshops.



Presenters



Presenter Index

A-E

A

Abbey, Elizabeth
Poster 25

Abrisch, Amanda
Topical Session 5

Ackley, Steve
Poster 4

Adams Grossjohann, Candace
Topical Session 3

Aguilar, Karen
Topical Session 7

Alberg, Joni
Topical Session 1, Topical Session 4

Allen, Mary Gywn
Topical Session 6

Aponte, Sondi
Poster 20

Armour, Brian
Topical Session 4

Aveni, Kathryn P.
Poster 31

Biando, Linda
Poster 31

Blaiser, Kristina
Topical Session 4, Poster 34

Blanchard, Erika
Poster 22

Blok, Kendra
Poster 9, Poster 10

Boerst, Angelique
Topical Session 1, Poster 6

Bolek, Lauren
Poster 27

Bosson, Lisa
Topical Session 1

Bowman, Kate
Poster 30

Bowman, Tonya
Poster 36

Brackett, Diane
Poster 9, Poster 10

Brown, Cedric
Poster 39

Coffield, Caroline
Poster 31

Coryell, Judy
Topical Session 7

Coverstone, Kirsten
Topical Session 3, Topical Session 5

Crace, Jodee
Topical Session 5

Cundall, Jacque
Topical Session 7

Curry, Alicia
Poster 1

Cushner, Debra
Topical Session 4

B

Baca, Rosalinda
Topical Session 5, Topical Session 7

Balch, Brenda
Topical Session 2

Baroch, Kelly, A.
Topical Session 6

Barry, Colleen
Topical Session 7

Beals, Martin
Topical Session 1

Beams, Dinah
Topical Session 4

Beavers, Jim
Topical Session 4

Becker, Kristen
Topical Session 1

Behl, Diane
Topical Session 2, Poster 5

Benedict, Beth
Topical Session 7

Bentler, Ruth
Topical Session 6

Beres-Sochka, Leslie
Poster 31

Bialek, Stephanie
Poster 38, Poster 39

Brown, Nicole
Topical Session 3

Burns, Shannon
Topical Session 1, Topical Session 5,
Poster 7

C

Calandro, Meghan
Poster 18, Poster 19

Cannon, Michael
Poster 38, Poster 39

Caraway, Teresa
Topical Session 7

Chant, Marcy
Topical Session 2

Choo, Daniel
Topical Session 4

Chung, Winnie
Topical Session 2, Topical Session 4,
Topical Session 7

Cire, George
Topical Session 7

Clark, Karen
Topical Session 2, Topical Session 6

Clark, Terrell
Topical Session 4, Topical Session 5

Claycomb, Stacy
Topical Session 1, Topical Session 5

D

Dagenais, Katie
Topical Session 4

Dalbec, Barb
Topical Session 5

Dalpes, Molly
Topical Session 5

Davis-Pedrie, Denise
Topical Session 4, Topical Session 5

Dayalu, Rashmi
Topical Session 1

DeMoss, Wendy
Topical Session 7

DesGeorges, Janet
Topical Session 1, Topical Session 5

Dilaj, Kristin
Poster 9, Poster 10

Din, Erica
Poster 39

Ditty, Karen
Topical Session 4, Topical Session 7

Doughty, Elizabeth
Poster 34

Dufour, Brigitte
Topical Session 5, Poster 20

E

Edwards, Mary
Poster 27

Egbert, Stella
Topical Session 1

Eiserman, William
Topical Session 1

Estes, Ellen
Topical Session 5

**F**

Fainberg, Jolie
Poster 40

Fairbanks, Sarah
Poster 15

Farrell, Janet
Topical Session 1, Topical Session 3

Felice, Janet
Topical Session 5

Fifer, Robert
Topical Session 2

Fort, Marcia
Topical Session 6

Foust, Terry
Topical Session 1, Topical Session 2

Fowler, Karen
Topical Session 6

Fried, Jan
Topical Session 7

Friedman Narr, Rachel
Topical Session 6

G

Gabbard, Sandra
Topical Session 1, Topical Session 5,
Poster 7

Gaffney, Claudia
Topical Session 5, Poster 1

Gallegos, Rosemary
Topical Session 1

Garcia, Michelle
Topical Session 1

Gatzemeyer, Meredith
Topical Session 2

Geslin, David
Topical Session 4

Gilkerson, Jill
Topical Session 7

Gill, Ellen
Topical Session 3

Gionet, Ann
Topical Session 2

Girard, Nicole
Poster 12

Goberis, Dianne
Topical Session 5

Grant-See, Cindy
Topical Session 5

Grimes, Alan
Topical Session 4

Grosse, Scott
Poster 38, Poster 39

H

Hamilton, Harley
Topical Session 1

Hankins, Liz
Poster 42

Hanks, Wendy
Topical Session 5, Poster 4

Harrison, Melody
Topical Session 6

Hartblay, Marian
Poster 43

Hartnett, Mary
Topical Session 2

Harward, Richard
Topical Session 6

Hayes, Cathrine
Poster 27

Hayes, Deborah
Poster 33

Hecht, Barbara
Poster 8

Hedley-Williams, Andrea
Poster 27

Hess, Mary Catherine
Topical Session 6

Hice, Mandy
Topical Session 6

Hoffman, Jeff
Topical Session 1, Topical Session 2,
Topical Session 4

Hollabaugh, Jeanne
Topical Session 5

Holte, Lenore
Topical Session 6

Honigfeld, Lisa
Topical Session 2

Hood, Linda
Poster 27

Hossler, Tami
Topical Session 4

Houston, K. Todd
Topical Session 2, Poster 34

Howell, Jennifer
Topical Session 4

Hunting, Vicki
Topical Session 4

Hutchinson, Nicole
Topical Session 2, Topical Session 5

Hutsell Guignard, Gayla
Topical Session 5, Topical Session 6,
Poster 28

I

Iwamoto, Lynn
Poster 32

J

Jacobs, Shana
Topical Session 6, Poster 30

Jeep, Chandace
Topical Session 5

Joesoef, Riduan
Poster 38

Johnson, Harold
Topical Session 6

K

Kammerer, Betsy
Topical Session 4

Karch, Stephanie
Poster 2

Keck, Camille
Poster 36

Kelly-Jones, Nancy
Topical Session 1, Topical Session 4

Kennedy, Sara
Topical Session 4, Topical Session 5

King, Adrienne
Topical Session 1

Kisler, Nancy
Topical Session 2

Kleindienst, Samantha
Poster 2

Klopfer, Ben
Topical Session 6

Knudson Chouffi, Brenda
Topical Session 3

Kohnert, Kathryn
Topical Session 4

Kovacs, Lisa
Topical Session 2, Topical Session 5

L

Lang, Lorie
Topical Session 7

PRESENTER INDEX

L-R



Larsen, Rebecca

Topical Session 5

LaSasso, Carol

Poster 4

Lasker, Linda

Topical Session 3

Lawrence, Cindy

Topical Session 5, Topical Session 6

Lawson, Melissa

Topical Session 3

Layne, Benjamin

Poster 16, Poster 19

Lee, Mellanie

Topical Session 7

Leitz, Curt

Topical Session 5

Leung, Jessica

Poster 38

Levine, Jack

Topical Session 3

Licameli, Greg

Topical Session 4

Lin, Xi

Poster 37

Lindow Davies, Candace

Topical Session 5

Lopez, Lisa

Poster 13, Poster 14

Lowrance, Kat

Topical Session 4

M

Malerba, Allison

Topical Session 3

Martin, Patti

Topical Session 3, Topical Session 7, Poster 35

Mason, Craig

Topical Session 4

McClellan, Mandy

Topical Session 7, Poster 35

McCollister, Faye

Topical Session 6

McCurley, Sheila

Poster 16, Poster 17, Poster 18, Poster 19

McDonald, Melissa

Topical Session 4

McNally, Anne

Topical Session 6

Meinzen-Derr, Jareen

Topical Session 4

Miller, Gary

Topical Session 1

Mister, Angie

Poster 24

Mitchiner, Julie

Topical Session 5, Poster 41

Moeggenberg, Carissa

Topical Session 4

Moeller, Mary Pat

Topical Session 2, Topical Session 6

Moosman, Molly

Poster 34

Morris, Barbara

Poster 26

Morrison, Helen

Poster 13

Morrow, Hallie

Topical Session 1, Topical Session 7

Muhs, Jill

Topical Session 6

Mullin, Ginger

Topical Session 2, Topical Session 7, Poster 16, Poster 17, Poster 18, Poster 19

Mullings, Day

Topical Session 4, Topical Session 6

Munoz, Karen

Topical Session 4, Topical Session 5, Topical Session 6, Poster 30

Muse, Carianne

Topical Session 2

N

Neidt, Karin

Poster 3

Nelson, Lauri

Topical Session 4, Topical Session 5

Nelson, Peggy

Topical Session 4

Ne vins, Mary Ellen

Topical Session 4

Nicholson, Nannette

Topical Session 3, Topical Session 7, Poster 35

Nussbaum, Debra

Topical Session 7

O

O'Hern, Megan

Topical Session 5

O'Hollearn, Tammy

Topical Session 2, Topical Session 6

Odeh, Valerie

Topical Session 5

Olsen, Lylis

Topical Session 7

Osbahr, Tracy

Topical Session 3

P

Page, Thomas

Topical Session 6

Pajak, Nancy

Topical Session 7

Patkin, Debra

Topical Session 4, Topical Session 5

Patterson, Terri

Topical Session 1

Perrodin, Brenda

Topical Session 4

Peter, Katina

Topical Session 7

Pitt, Cache

Poster 42

Pittman, Paula

Topical Session 5

Poole, Bridget

Topical Session 4

Powell, Meghan

Topical Session 3, Poster 35

Pretto, Aneesha

Topical Session 4

Q

Quenin, Cathy

Topical Session 5, Topical Session 6

R

Radeen, Marion

Topical Session 3

Ragin, Rachael

Topical Session 6

Raimondo, Barbara

Topical Session 4, Topical Session 1

Randall, Kurt

Topical Session 3

**Rank, Sarah**

Topical Session 3

Reynolds, David

Topical Session 4

Richardson, Brittany

Poster 29

Richardson, Stevenson

Topical Session 4, Poster 1

Roberson, Kathy

Poster 31

Robert, Steve

Poster 2

Roche, Elisa

Poster 8

Rodriguez, Lindsay

Poster 13, Poster 14

Roemmich, Bridget

Topical Session 1

Ross, Danielle

Poster 39

Roush, Jackson

Topical Session 2, Poster 29, Poster 30

Roush, PatriciaTopical Session 2, Topical Session 6,
Poster 29**Ruberl, Amy**

Topical Session 5, Topical Session 6

Rushmer, Nancy

Topical Session 7

S**Sabo, Diane**

Topical Session 4

Sager, Nancy Grosz

Poster 11

Sanchez, Irma

Topical Session 6

Sass-Lehrer, MarilynPoster 11, Topical Session 2,
Topical Session 5**Satterfield, Lisa**

Topical Session 1

Schlegel, Sarah

Topical Session 2

Schmeltz, Les

Topical Session 4

Schneider, Nancy

Poster 31

Schulte, Julie

Topical Session 6, Poster 28

Schuweiler, Erin

Topical Session 1

Seal, Brenda

Topical Session 5

Seaver, Leeanne

Topical Session 1

Sedey, Allison

Topical Session 3

Seeliger, Elizabeth

Topical Session 5

Sette, Alice

Topical Session 3

Sexton, Johnnie

Topical Session 1

Sexton, Judy

Topical Session 1

Shahid, Cora

Topical Session 4

Shapley, Kathy

Poster 35

Shaw, Sarah

Topical Session 6

Sherwood, Jennifer

Topical Session 1

Shisler, Lenore

Topical Session 1

Sorkin, Donna

Topical Session 4, Topical Session 5

Spann, M. Joshua

Topical Session 3

Spicer, Gretchen

Topical Session 5

Spitalnik, Deborah M.

Poster 31

St. John, Rachel

Topical Session 1

Stanley, Alice

Topical Session 3

Starner, Thad

Topical Session 1

Stern, Ronald

Topical Session 1

Stone, Sarah

Topical Session 1, Topical Session 3

Storbeck, Claudine

Topical Session 5

Stredler Brown, Arlene

Topical Session 2

Stremel, Kathleen

Topical Session 1

Sullivan, Claire

Topical Session 6

Sullivan, Mary Jane

Topical Session 5

Summet, Valerie

Topical Session 1

Swafford, Meuy

Topical Session 1

Swann, Maryann

Topical Session 1

T**Talkington, Rebekah**

Poster 35

Tedford, Tori

Topical Session 7

Theobald, Corine

Topical Session 5

Therres, MaryKay

Topical Session 1

Thomson, VickieTopical Session 4, Topical Session 5,
Topical Session 7**Thorud, Jennifer**

Topical Session 2

Timm, Patricia

Poster 15

Tomblin, Bruce

Topical Session 6

Toro, Margaret

Poster 21

Tucker, Alison

Topical Session 7

U**Uhler, Kristin**

Topical Session 5, Poster 7

Usrey, Sandra

Topical Session 1

V**VanBiervliet, Alan**

Topical Session 3

Vohr, Betty

Poster 12

Volle, Meredith

Poster 17, Poster 19

PRESENTER INDEX

W-Z



W

Waldron, Debra

Topical Session 4

Wallace, Jennifer

Topical Session 7

Waller, Garland

Topical Session 4

Wang, Chengbin

Poster 39

Warnock, Madelyn

Topical Session 3

Watkins, Linsey

Poster 27

Watts, Kathleen

Topical Session 1, Topical Session 2

Weaver, Kimberly

Topical Session 1

Weekley, David

Topical Session 3

Wen, Natasha

Topical Session 3, Topical Session 1

Wentworth, Richard

Topical Session 1

Wiggins, Mallene

Topical Session 7

Wiley, Susan

Topical Session 1, Topical Session 4

Wilson, Melissa

Topical Session 4

Winston, Randi

Topical Session 7, Poster 23

Wiorek, Lori

Topical Session 5



Y

Yoshinaga-Itano, Christine

Topical Session 3, Topical Session 5,

Topical Session 7

Z

Ziegberman, Jana

Topical Session 2

PARTICIPANT LIST

A copy of the participant list and exhibitor list is located in the back of the pocket inserts.



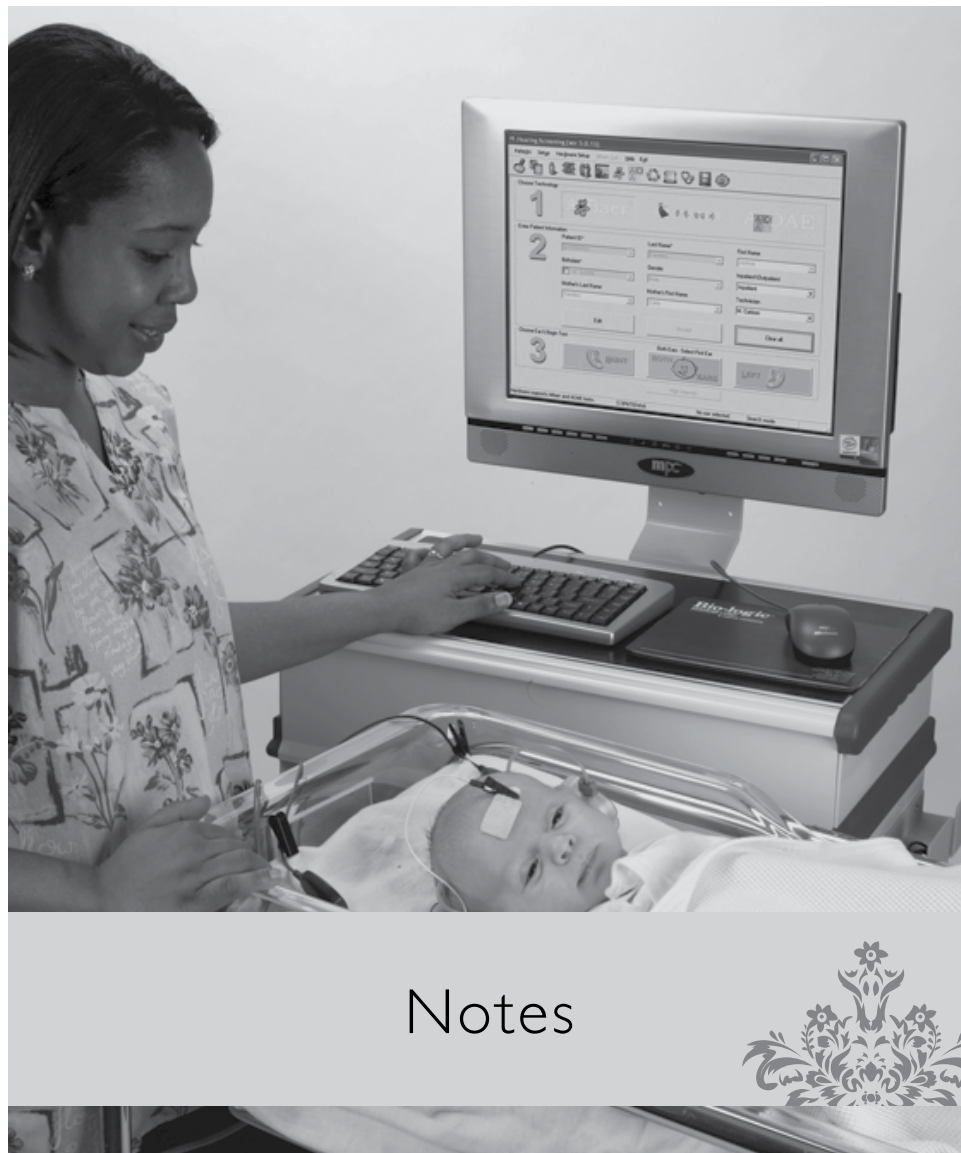

Notes



SESSION NOTES AND APPLICATION

Use this form to record key messages from each session you attend and how you will apply information from the session.

Monday, February 21, 2011

Opening Plenary: Ten Years of EHDl

Key Messages	Application

State Stakeholders' Meeting

Key Messages	Application

Topical Session I

Key Messages	Application



SESSION NOTES AND APPLICATION

Use this form to record key messages from each session you attend and how you will apply information from the session.

Monday, February 21, 2011

Poster Session

Key Messages	Application

Topical Session 2

Key Messages	Application

Topical Session 3

Key Messages	Application



SESSION NOTES AND APPLICATION

Use this form to record key messages from each session you attend and how you will apply information from the session.

Monday, February 21, 2011

Plenary II: It's All About the Expectations

Key Messages	Application

Tuesday, February 22, 2011

Plenary III: The Medical Home and EHDI

Key Messages	Application

Topical Session 4

Key Messages	Application



SESSION NOTES AND APPLICATION

Use this form to record key messages from each session you attend and how you will apply information from the session.

Tuesday, February 22, 2011

Topical Session 5

Key Messages	Application

Topical Session 6

Key Messages	Application

Topical Session 7

Key Messages	Application

Closing Plenary: EHDI & Family Support: Past, Present & Future

Key Messages	Application



Lined writing area consisting of multiple horizontal lines for notes.

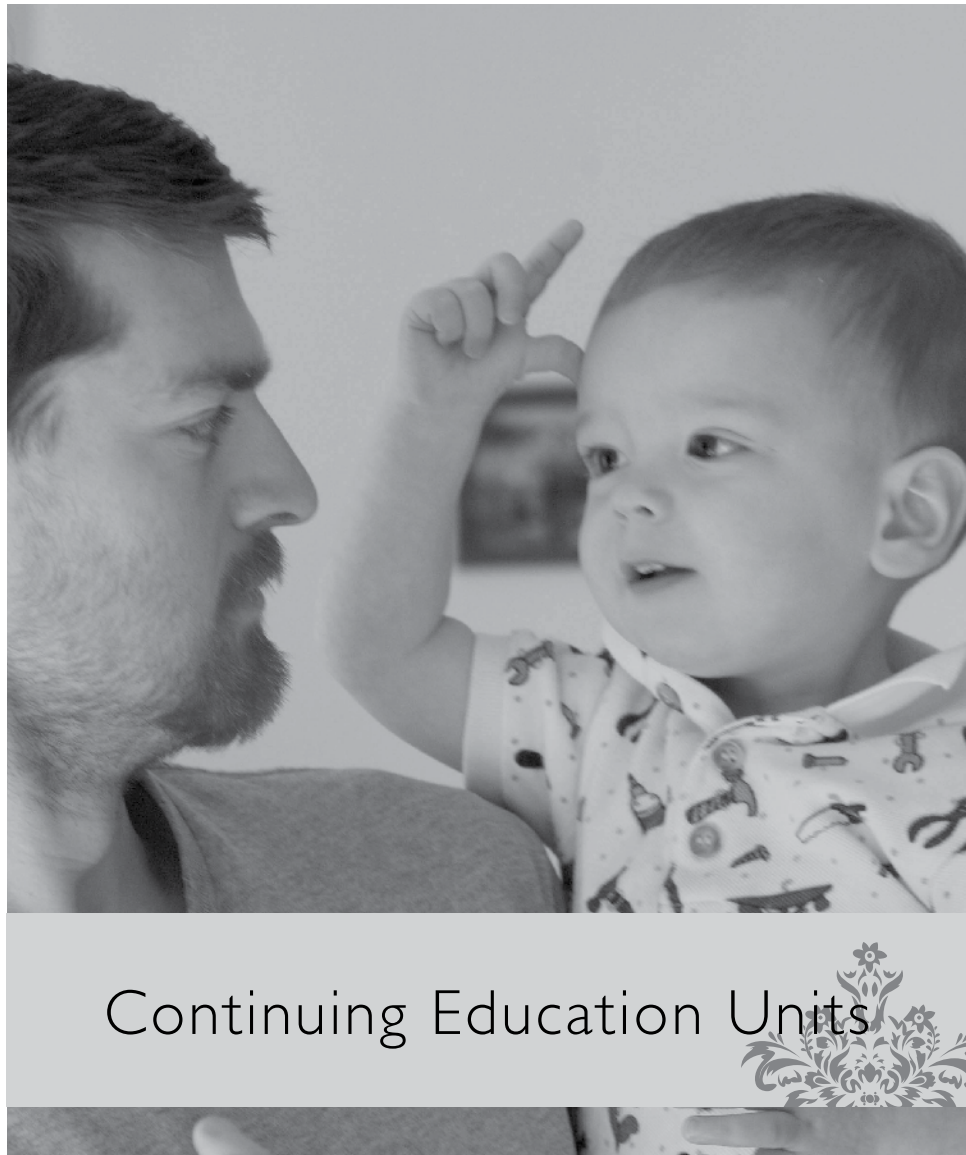

Continuing Education Units

Continuing Education Units (CEUs)

AG Bell Academy for Listening and Spoken Language



The overall conference has been approved for up to 5 CE credits for the pre-conference programs, and up to 6 CE credits for the conference sessions by the AG Bell Academy for Listening and Spoken Language.

American Academy of Audiology



The National Center for Hearing Assessment and Management (NCHAM) has been approved by the American Academy of Audiology to offer Academy CEUs for the 2010 EHDI Conference.

The program is worth a maximum of 1.6 CEUs (this includes up to 5 hours of pre-conference sessions).

Academy approval of this continuing education activity does not imply endorsement of course content, specific products, or clinical procedures.



American Speech-Language-Hearing Association

This course is offered for up to ___ ASHA CEUs (Various level, Professional area).

The National Center on Hearing Assessment and Management has submitted an application to American Speech-Language-Hearing Association to offer CEUs for the 2011 EHD conference.

The program may be worth a maximum of 1.6 CEUs, if approved. Instructions and the required paperwork will be available in the CEU Tab of your conference packet. Approval of this continuing education activity does not imply endorsement of course content, specific products, or clinical procedures.

Certificate of Conference Attendance

A personalized certificate of attendance, including the total contact hours for the

Instructions for CEU Credit

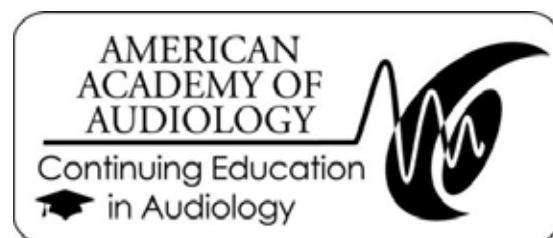

The 10th Annual Early Hearing Detection and Intervention (EHDI) Conference
February 20 – February 22, 2011 ♦ Atlanta, Georgia

AAA CEU Instructions

- Fill out evaluations for the topical and poster sessions that you attend
 - Write your name on the session evaluation for each session you attend
 - Mark the AAA box at the top of each session evaluation you complete
 - Turn in each evaluation to the room monitor at the end of each session
 - A minimum of 9 posters must be evaluated in order to receive maximum CEU credit for poster sessions.
- Complete **both sides** of the attached AAA Attendance Form/Learner Assessment
- Turn in your completed AAA Attendance Form/Learner Assessment to the conference registration desk before you leave the conference

If we do not receive your form by February 22, you will have to submit it to AAA directly.

What can be counted for the CEU:

- Classroom or meeting session time led by instructor and/or discussion leader;
- Activities in which a learner is engaged in a planned activity, course or program of learning in which the learner's progress is monitored and the learner receives feedback.

CEU Definition

One CEU = ten contact hours of participation in an organized continuing education/training experience under responsible, qualified direction and instruction.

What CANNOT be counted for the CEU:

- Unplanned, unsupervised, non-sponsored events
- Academic credit courses
- Association membership leadership activities
- Committee meetings
- Entertainment and recreation
- Travel
- Work experience
- Factory tours
- Some meetings, convention, and exhibitions: Meetings/activities conducted primarily for information sharing purposes, generally do not qualify for the CEUs. Planned learning activities within such events, which meet the criteria, are eligible for the CEU.

Fold & tear on perforation

Attendance Form for CEU Credit



The 10th Annual Early Hearing Detection and Intervention (EHDI) Conference February 20 – February 22, 2011 * Atlanta, Georgia

Name _____ AAA Member Number* _____
 Address _____ Phone _____
 _____ E-mail _____

*If you don't know your AAA member number, email membership@audiology.org or call 800-AAA-2336.

Mark if Attended	Session	Contact Hours	Presentation Attended
	Pre-session	(max 5 hours)	Please choose no more than 2 pre-sessions attended
<input type="checkbox"/>		2 hours	<i>Language Acquisition and Brain Development of Children who are D/HH</i>
<input type="checkbox"/>		2 hours	<i>IDEA Training for EHDI Professionals</i>
<input type="checkbox"/>		4 hours	<i>Culturally Competent Practices in EHDI</i>
<input type="checkbox"/>		4 hours	<i>The Pediatric Medical Home and EHDI</i>
<input type="checkbox"/>		3 hours	<i>IDEA Training for Parents</i>
<input type="checkbox"/>		3 hours	<i>Early Childhood Hearing Screening</i>
<input type="checkbox"/>		2 hours	<i>Using IT Applications for EHDI</i>
<input type="checkbox"/>	Opening Plenary I	1 hour	<i>Ten Years of EHDI</i>
<input type="checkbox"/>	Topical Session 1	1 hour	_____
<input type="checkbox"/>	Poster Session	1 hour	_____
<input type="checkbox"/>	Topical Session 2	1 hour	_____
<input type="checkbox"/>	Topical Session 3	0.50 hour	_____
<input type="checkbox"/>	Plenary II	1 hour	<i>It's All About Expectations</i>
<input type="checkbox"/>	Plenary III	1 hour	<i>The Medical Home and EHDI</i>
<input type="checkbox"/>	Topical Session 4	1 hour	_____
<input type="checkbox"/>	Topical Session 5	1 hour	_____
<input type="checkbox"/>	Topical Session 6	1 hour	_____
<input type="checkbox"/>	Topical Session 7	0.50 hour	_____
<input type="checkbox"/>	Closing Plenary IV	1 hour	<i>EHDI & Family Support: Past, Present and Future</i>

Total Contact Hours Attended: _____ **x 0.1 =** _____ **CEUs**

-- Remember to Complete the Questions on the Back Side --

Please return this form to the Registration Desk before leaving the conference.



Learner Assessment for American Academy of Audiology CEU Credit

The 10th Annual Early Hearing Detection and Intervention (EHDI) Conference February 20-22, 2011 • Atlanta, Georgia

Completion of the learner assessment is required to receive CEU credit from the American Academy of Audiology. Please answer the following questions and turn in this form at the registration table before leaving the meeting.

1. According to a look at the past 10 Years of EHDI and a look ahead, what is the most important change EHDI programs need to make?
 - a. Increase the percentage of infants screened for hearing loss
 - b. Decrease the number of infants who do not pass hearing screening and are lost to follow-up
 - c. Decrease the options families have for intervention services
 - d. Decrease reimbursement rates for clinical providers
 - e. Increase the time between diagnosis and referral

2. In 2011, approximately how many attorneys in the USA now are self-identified as deaf or hard of hearing?
 - a. 25
 - b. 250
 - c. 2,500
 - d. Too Many

3. Which of the following is an example of a "Just-in-Time" learning model?
 - a. The physician reads a textbook paragraph about hearing loss before entering the exam room to see a child who failed the hearing screening test.
 - b. The physician googles the words "pediatric hearing loss" after receiving a report about a failed newborn hearing screen on one of his newborn patients.
 - c. The physician receives a fax from the audiologist containing a confirmed hearing loss report along with a one-page informational/educational tool
 - d. The physician has his staff call for any missing screening report on the morning prior to a child's two week visit in the office
 - e. The physician telephones the otolaryngologist to find out what to do next when seeing a baby identified with hearing loss.

4. Name one of the elements of support that can help to enhance involvement by families who are considered 'under-involved'?
 - a. Exposure to other parents who can model positive behaviors
 - b. Sharing research about the importance of family involvement
 - c. Billing families for missed appointments

Please return this form to the Registration Desk before leaving the conference.

American Speech-Language-Hearing Association

ASHA CEU Instructions

The 10th Annual Early Hearing Detection and Intervention (EHDI) Conference
February 20 – February 22, 2011 ♦ Atlanta, Georgia

Instructions

- Fill out evaluations for the topical and poster session that you attend
 - Write your name on the session evaluation for each session you attend
 - Mark the ASHA box at the top of each session evaluation you complete
 - Turn in each evaluation to the room monitor at the end of each session as you leave
- Calculate the number of total contact hours you attended (using the form below)
- Write the number of contact hours in the upper right-hand corner of the attached “Participant Form” (this number will be converted to CEUs for you)
- **Complete the attached “Participant Form” including your ASHA number**
- **Return the “Participant Form” to the EHDI Conference Registration Desk at conference end**

If we do not receive your form by February 22, you will not receive ASHA credit

Mark if Attended	Session	Contact Hours	Presentation Attended
	Pre-session	5 hours	Please choose no more than 2 sessions attended
<input type="checkbox"/>		2 hours	<i>Language Acquisition and Brain Development of Children who are D/HH</i>
<input type="checkbox"/>		2 hours	<i>IDEA Training for EHDI Professionals</i>
<input type="checkbox"/>		4 hours	<i>Culturally Competent Practices in EHDI</i>
<input type="checkbox"/>		4 hours	<i>The Pediatric Medical Home and EHDI</i>
<input type="checkbox"/>		3 hours	<i>IDEA Training for Parents</i>
<input type="checkbox"/>		3 hours	<i>Early Childhood Hearing Screening</i>
<input type="checkbox"/>		2 hours	<i>Using IT Applications for EHDI</i>
<input type="checkbox"/>	Opening Plenary I	1 hour	<i>Ten Years of EHDI</i>
<input type="checkbox"/>	State Stakeholders' Meeting	0.75 hour	_____
<input type="checkbox"/>	Topical Session 1	1 hour	_____
<input type="checkbox"/>	Poster Session	1 hour	_____
	*Must review 6 posters		
<input type="checkbox"/>	Topical Session 2	1 hour	_____
<input type="checkbox"/>	Topical Session 3	0.50 hour	_____
<input type="checkbox"/>	Plenary II	1 hour	<i>It's All About Expectations</i>
<input type="checkbox"/>	Plenary III	1 hour	<i>The Medical Home and EHDI</i>
<input type="checkbox"/>	Topical Session 4	1 hour	_____
<input type="checkbox"/>	Topical Session 5	1 hour	_____
<input type="checkbox"/>	Topical Session 6	1 hour	_____
<input type="checkbox"/>	Topical Session 7	0.50 hour	_____
<input type="checkbox"/>	Closing Plenary IV	0.75 hour	<i>EHDI & Family Support: Past, Present and Future</i>

Total Contact Hours Attended

(Write the number of hours on the top right corner of the “ASHA Participant Form” located in the back pocket inserts)

AG Bell Academy for Listening and Spoken Language



Application Instructions

The overall conference has been approved for up to 5 CE credits for the pre-conference programs, and up to 6 CE credits for the conference sessions by the AG Bell Academy for Listening and Spoken Language.

Please review and complete AG Bell CEU forms located in the back pocket of the program book.





Evaluations



	February 20 – February 22, 2011 Omni Hotel at CNN Center • Atlanta, Georgia
---	--

Overall Conference Evaluation Form

Please mark all of the following entities that you represent:

- | | | |
|--|---|--|
| <input type="checkbox"/> Advocacy Group | <input type="checkbox"/> Hospital/Birthing Center | <input type="checkbox"/> State Health Department |
| <input type="checkbox"/> Audiologist | <input type="checkbox"/> Local Health Dept | <input type="checkbox"/> Student |
| <input type="checkbox"/> Early Intervention Provider | <input type="checkbox"/> Medical Provider | <input type="checkbox"/> University |
| <input type="checkbox"/> Family of a Child with Hearing Loss | <input type="checkbox"/> Non-Profit Agency | <input type="checkbox"/> Other (please specify): _____ |
| <input type="checkbox"/> Federal Agency | <input type="checkbox"/> Part C Agency/Provider | _____ |
| | <input type="checkbox"/> State Education Agency | _____ |

Conference Goal: The goal of this conference is to enhance the implementation of comprehensive state-based Early Hearing Detection and Intervention (EHDI) programs.

Please circle the number that best represents your opinion regarding the entire conference.

		Strongly Disagree			Strongly Agree
1. I am confident that I can promote knowledge/awareness of successful EHDI implementation strategies.	1	2	3	4	5
2. I am confident that I can share current research and research methods related to EHDI.	1	2	3	4	5
3. I am confident that I can improve cultural competence in working with children/families/communities.	1	2	3	4	5
4. I am confident that I can enhance and develop new working relationships with various groups/agencies.	1	2	3	4	5
5. The conference content was relevant to my work or participation in the EHDI system.	1	2	3	4	5
6. The conference was effective in addressing current EHDI issues.	1	2	3	4	5
7. The information presented in Plenary Session I, Ten Years of EHDI , was useful.	1	2	3	4	5
8. The information presented in Plenary Session II, It's All About Expectations , was useful.	1	2	3	4	5
9. The information presented in Plenary Session III, The Medical Home and EHDI , was useful.	1	2	3	4	5
10. The information presented in Plenary Session IV, EHDI and Family Support , was useful.	1	2	3	4	5
11. The State Stakeholder's Meeting time was useful for networking with others in my state/region.	1	2	3	4	5
12. The length of the conference was adequate for learning.	1	2	3	4	5
13. The length of time available for networking with others was adequate.	1	2	3	4	5
14. The process for obtaining Continuing Education Units (CEUs) was easy to understand.	1	2	3	4	5
15. The pre-registration process was well organized.	1	2	3	4	5
16. The on-site registration process was well organized.	1	2	3	4	5
17. Conference staff effectively answered questions and assisted participants.	1	2	3	4	5
18. The hotel meeting facilities were appropriate for the conference.	1	2	3	4	5
19. The conference provided adequate audio-visual equipment and technical support.	1	2	3	4	5
20. What specific topics would you like included on the conference program in the future?					

21. Additional comments/suggestions/observations: _____

THANK YOU FOR YOUR FEEDBACK! Please return this completed form to the Registration Desk before you leave OR FAX to: Casey Judd at 435-797-0036, no later than March 16, 2011.

Answer the following if requesting CME through American Academy of Pediatrics (AAP)

(If not requesting CME, leave blank)

American Academy of Pediatrics Continuing Medical Education (CME) credit

Name: _____

1. How would you rate your overall satisfaction with this CME activity?

Not Satisfied		Satisfied		Very Satisfied
1	2	3	4	5

2. How well did this CME activity meet your educational needs?

Did NOT Meet Needs		Met Needs		Exceeded Needs
1	2	3	4	5

3. How important was the AAP's reputation as a CME provider in your decision to participate in this CME activity?

Not Important		Somewhat Important		Very Important
1	2	3	4	5

4. Do you feel a commercial product, device, or service was inappropriately promoted in the educational content?

___ No
___ Yes - If yes, please comment: _____

5. Do you feel that the educational content was free of unsubstantiated personal bias?

___ Yes
___ No - If no, please comment: _____

Outcomes-based Questions

Please review the directions communicated in the CME Outcomes Project.

If you are implementing Model III: Global Evaluation of the Learning Activity (which will not be following up with individual learners), the outcomes-based question below (1a, 1b, and 1c) should be included along with the required questions provided above.

1a. As a result of participating in this learning activity, do you intend to make a change in practice to provide better patient care? ___Yes ___No

If yes: 1b. Please *describe* what you will *do differently* in practice: _____

1c. How will you accomplish this change in practice?: _____



**February 20 – February 22, 2011
Omni Hotel at CNN Center • Atlanta, Georgia**

Poster Evaluation Form

Name _____

AAA CEU Credit (must complete a total of 9 poster evaluation forms)

ASHA CEU Credit (must complete a total of 6 poster evaluation forms)

Additional copies of this form are available at the poster sessions and the Conference Registration Desk.

Please mark **all** of the following entities that you represent:

- | | | |
|--|---|--|
| <input type="checkbox"/> Advocacy Group | <input type="checkbox"/> Hospital/Birthing Center | <input type="checkbox"/> State Health Department |
| <input type="checkbox"/> Audiologist | <input type="checkbox"/> Local Health Dept | <input type="checkbox"/> Student |
| <input type="checkbox"/> Early Intervention Provider | <input type="checkbox"/> Medical Provider | <input type="checkbox"/> University |
| <input type="checkbox"/> Family of a Child with Hearing Loss | <input type="checkbox"/> Non-Profit Agency | <input type="checkbox"/> Other (please specify): _____ |
| <input type="checkbox"/> Federal Agency | <input type="checkbox"/> Part C Agency/Provider | _____ |
| | <input type="checkbox"/> State Education Agency | _____ |

Poster #: _____ **Poster Presenter's Last Name:** _____

	Poor				Excellent	
Overall quality of poster presentation	1	2	3	4	5	
Organization / clarity of the poster	1	2	3	4	5	
Presentation (how well the presenter conveyed info during the session)	1	2	3	4	5	
Usefulness of information	1	2	3	4	5	
Relevance of topic	1	2	3	4	5	
Adequate opportunity to interact/engage with presenter(s)	1	2	3	4	5	
Usefulness of handouts / support materials (circle "NA" if no handout/materials)	1	2	3	4	5	NA

Additional comments: _____

Please return this form to the Conference Registration Desk before you leave the conference.

State Stakeholders' Meeting Evaluation Form

Please mark all of the following entities that you represent:

- | | | |
|--|---|--|
| <input type="checkbox"/> Advocacy Group | <input type="checkbox"/> Federal Agency | <input type="checkbox"/> State Education Agency |
| <input type="checkbox"/> Audiologist | <input type="checkbox"/> Hospital/Birthing Center | <input type="checkbox"/> State Health Department |
| <input type="checkbox"/> Early Intervention Provider | <input type="checkbox"/> Local Health Dept | <input type="checkbox"/> Student |
| <input type="checkbox"/> Family of a child with hearing loss | <input type="checkbox"/> Medical Provider | <input type="checkbox"/> University |
| | <input type="checkbox"/> Non-Profit Agency | <input type="checkbox"/> Other (please specify): _____ |
| | <input type="checkbox"/> Part C Agency/Provider | |

	Strongly Disagree			Strongly Agree
1. The pre-conference materials (State Stakeholders' Meeting Description and Pre-Conference Individual Reflection and Planning) helped me prepare for the EHDI Conference.	1	2	3	4 5
2. Participants from my state discussed the status of my state's EHDI system (goals, priorities, initiatives, etc.)	1	2	3	4 5
3. Participants from my state were able to determine which workshops would be most helpful for each participant to attend.	1	2	3	4 5
4. I was able to develop a plan to apply the new information that I learned at the conference to my state's EHDI system.	1	2	3	4 5
5. The organization, purpose, and activities for the State Stakeholders' Meeting were clear and easy to follow.	1	2	3	4 5
6. Recommendations for State Stakeholders' Meeting at next year's EHDI Conference:	<hr style="border: 0; border-top: 1px solid black; margin-bottom: 5px;"/> <hr style="border: 0; border-top: 1px solid black; margin-bottom: 5px;"/> <hr style="border: 0; border-top: 1px solid black;"/>			

Return this form to the Conference Registration Desk before you leave the

Please return this form to the Conference Registration Desk before you leave the conference.



Local Information & Hotel Map



LOCAL INFORMATION & TRANSPORTATION

<http://www.atlanta.net>

A perfect blend of cosmopolitan sophistication and southern hospitality, Atlanta knows how to host any visitor. And the Omni Hotel at CNN Center puts you close to so many Atlanta Attractions: the Georgia Dome, the Georgia World Congress Center, Philips Arena, the Georgia Aquarium, Centennial Olympic Park, the new World of Coca Cola Museum and more.

There are several restaurants within walking distance of the hotel:

Prime Meridian	(onsite)	Ruth's Chris (steakhouse)	1 block
Latitudes Bistro & Lounge	(onsite)	STATS Sports Bar	2 blocks
Taco Mac Sports Bar	(CNN center)	Legal Seafood	2 blocks
McCormick & Schmick's Seafood	(CNN center)	Maxim Prime	1 block

Transportation to Downtown Atlanta

www.itsmarta.com

The City of Atlanta and the surrounding metro area have something to offer almost everyone. Visitors and residents can find exciting entertainment at every corner and MARTA takes you there!

A MARTA stop is conveniently located adjacent to the hotel, the Dome/GWCC/Phillips Arena/CNN Center stop. Contact MARTA for schedules:

Call: 404-848-5000

TTY: 404-848-5665

Website: <http://itsmarta.com/visiting-atlanta.aspx>

Transportation options to and from the airport:

- Taxi Service: Approximately \$30 + per way
- Atlanta Airport Shuttle Service (AASC): (404) 762-3007
- Limo Service: Approximately \$90 - \$110 plus tax per way
- Sedan Service: Approximately \$70 – \$75 plus taxes and gratuities
- MARTA: Approximately \$2.75 each way. Take train North to the Five Points Station. Take a Westbound train 1 stop to CNN/ GWCC Station. Take escalator or elevator up and walk through CNN building to hotel entrance.

North Tower
M1/Street Level

- Breakout Sessions
- Luggage Storage
- Restrooms

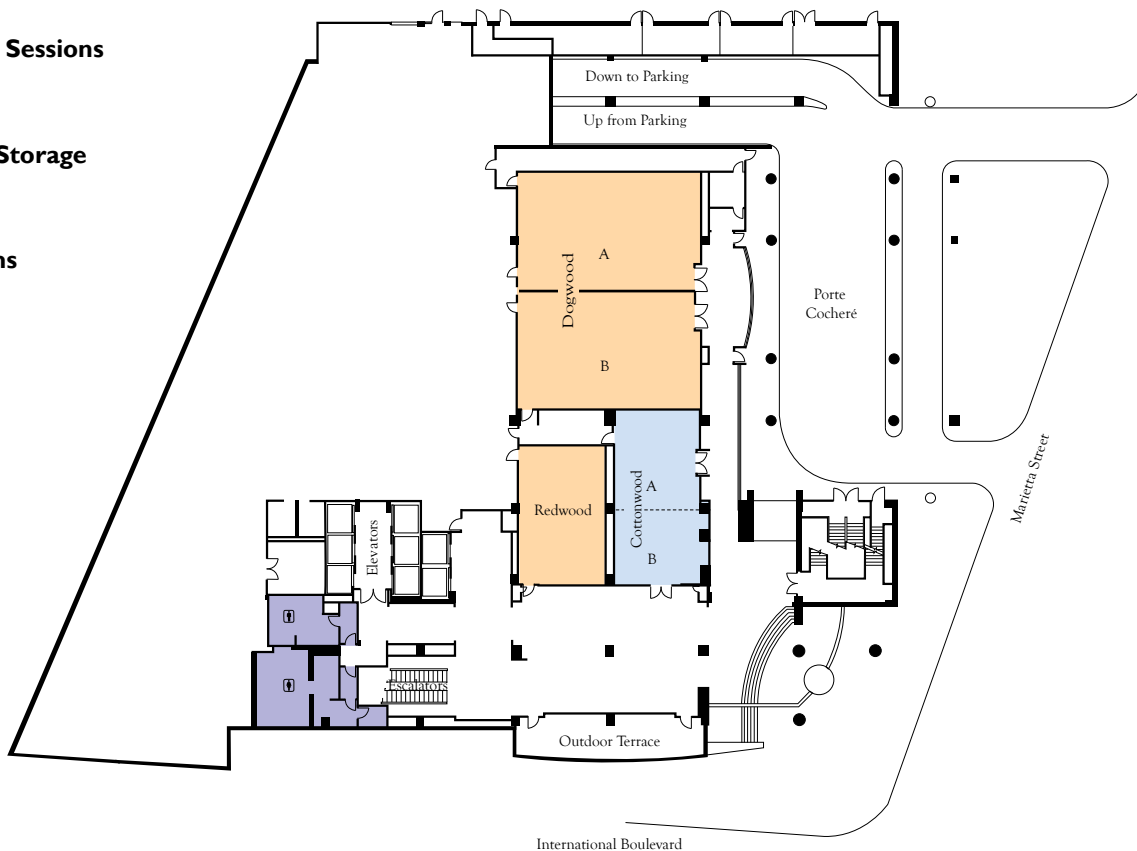

North Tower
M2/International Ballroom Level

- Breakout Sessions
- Speaker Ready Room
- Poster Session

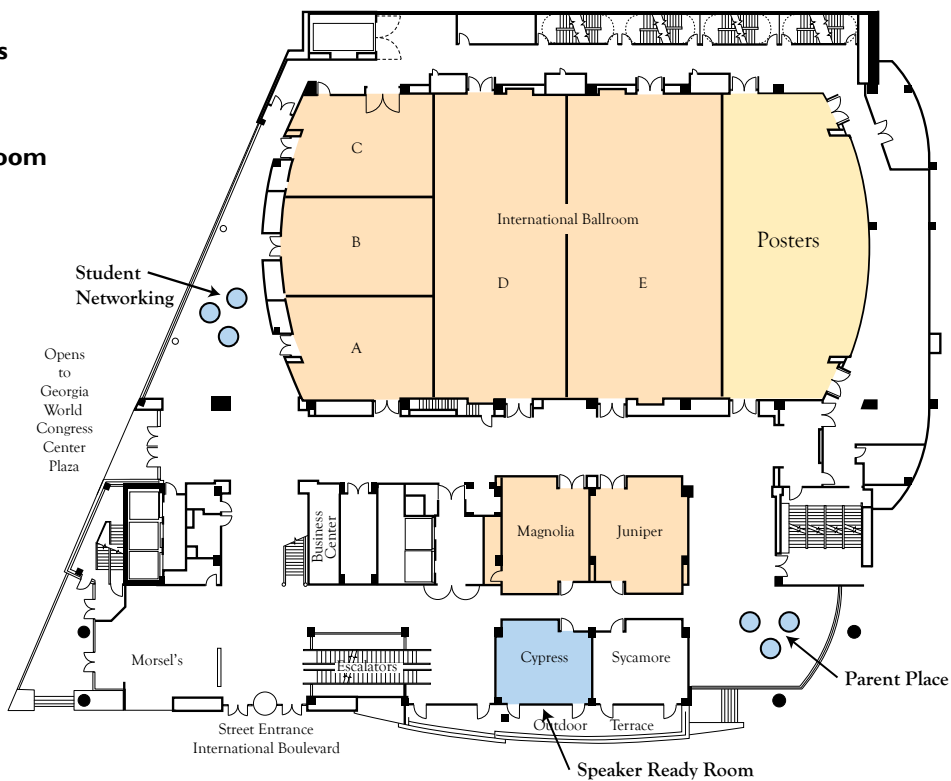

North Tower
M3/Meeting Level

- Breakout Sessions
- Restrooms



North Tower
M4/Grand Ballroom Level

- Plenary Sessions
- Exhibit Hall
- Registration

